



European Technical Approval ETA-09/0296

English translation prepared by DIBt - Original version in German language

Handelsbezeichnung
Trade name

Powers Injektionssystem AC100-PRO für Bewehrungsanschlüsse
Powers Injection system AC100-PRO for rebar connection

Zulassungsinhaber
Holder of approval

Powers Fasteners Europe
Stanley Black&Decker Deutschland GmbH
Black-&-Decker Str. 40
65510 Idstein
DEUTSCHLAND

Zulassungsgegenstand
und Verwendungszweck
*Generic type and use
of construction product*

Nachträglich eingemörtelter Bewehrungsanschluss mit dem
Powers Injektionssystem AC100-PRO
*Post-installed rebar connection with
Powers Injection System AC100-PRO*

Geltungsdauer:
Validity: vom
from
bis
to

16 May 2013
16 May 2018

Herstellwerk
Manufacturing plant

Powers Fasteners Europe B.V.
Factory 2, Germany

Diese Zulassung umfasst
This Approval contains

21 Seiten einschließlich 12 Anhänge
21 pages including 12 annexes

Diese Zulassung ersetzt
This Approval replaces

ETA-09/0296 mit Geltungsdauer vom 06.10.2009 bis 06.10.2014
ETA-09/0296 with validity from 06.10.2009 to 06.10.2014

I LEGAL BASES AND GENERAL CONDITIONS

- 1 This European technical approval is issued by Deutsches Institut für Bautechnik in accordance with:
 - Council Directive 89/106/EEC of 21 December 1988 on the approximation of laws, regulations and administrative provisions of Member States relating to construction products¹, modified by Council Directive 93/68/EEC² and Regulation (EC) N° 1882/2003 of the European Parliament and of the Council³;
 - *Gesetz über das In-Verkehr-Bringen von und den freien Warenverkehr mit Bauprodukten zur Umsetzung der Richtlinie 89/106/EWG des Rates vom 21. Dezember 1988 zur Angleichung der Rechts- und Verwaltungsvorschriften der Mitgliedstaaten über Bauprodukte und anderer Rechtsakte der Europäischen Gemeinschaften (Bauproduktengesetz - BauPG) vom 28. April 1998⁴, as amended by Article 2 of the law of 8 November 2011⁵;*
 - Common Procedural Rules for Requesting, Preparing and the Granting of European technical approvals set out in the Annex to Commission Decision 94/23/EC⁶;
 - Guideline for European technical approval of "Metal anchors for use in concrete - Part 5: Bonded anchors", ETAG 001-05.
- 2 Deutsches Institut für Bautechnik is authorized to check whether the provisions of this European technical approval are met. Checking may take place in the manufacturing plant. Nevertheless, the responsibility for the conformity of the products to the European technical approval and for their fitness for the intended use remains with the holder of the European technical approval.
- 3 This European technical approval is not to be transferred to manufacturers or agents of manufacturers other than those indicated on page 1, or manufacturing plants other than those indicated on page 1 of this European technical approval.
- 4 This European technical approval may be withdrawn by Deutsches Institut für Bautechnik, in particular pursuant to information by the Commission according to Article 5(1) of Council Directive 89/106/EEC.
- 5 Reproduction of this European technical approval including transmission by electronic means shall be in full. However, partial reproduction can be made with the written consent of Deutsches Institut für Bautechnik. In this case partial reproduction has to be designated as such. Texts and drawings of advertising brochures shall not contradict or misuse the European technical approval.
- 6 The European technical approval is issued by the approval body in its official language. This version corresponds fully to the version circulated within EOTA. Translations into other languages have to be designated as such.

¹ Official Journal of the European Communities L 40, 11 February 1989, p. 12
² Official Journal of the European Communities L 220, 30 August 1993, p. 1
³ Official Journal of the European Union L 284, 31 October 2003, p. 25
⁴ *Bundesgesetzblatt Teil I 1998*, p. 812
⁵ *Bundesgesetzblatt Teil I 2011*, p. 2178
⁶ Official Journal of the European Communities L 17, 20 January 1994, p. 34

II SPECIFIC CONDITIONS OF THE EUROPEAN TECHNICAL APPROVAL

1 Definition of product and intended use

1.1 Definition of the construction product

The subject of this approval is the post-installed connection, by anchoring or overlap connection joint, of reinforcing bars (rebars) in existing structures made of normal weight concrete, using the "Powers Injection system AC100-PRO for rebar connection" in accordance with the regulations for reinforced concrete construction.

Reinforcing bars made of steel with a diameter d_s from 8 to 25 mm according to Annex 3 and Powers injection mortar AC100-PRO are used for rebar connections. The rebar is placed into a drilled hole filled with injection mortar and is anchored via the bond between rebar, injection mortar and concrete.

1.2 Intended use

The rebar connection may be used in normal weight concrete of a minimum grade of C12/15 and maximum grade C50/60 according to EN 206-1:2000. It may be used in non-carbonated concrete with the allowable chloride content in concrete of 0.40% (CL 0.40) related to the cement content according to EN 206-1.

Rebar connections with reinforcing bars may be used for predominantly static loads.

The fire resistance of post-installed rebar connections is not covered by this European technical approval. Fatigue, dynamic or seismic loading of post-installed rebar connections are not covered by this European technical approval.

Rebar connections may only be carried out in a manner, which is also possible with cast-in straight reinforcing bars, e.g. those in the following applications (see Annexes 2):

- an overlap joint with existing reinforcement in a building component (Figures 1 and 2),
- anchoring of the reinforcement at a slab or beam support, (e.g. according to Figure 3: end support of a slab, designed simply supported, as well as an appropriate general reinforcement for restraint forces),
- anchoring of reinforcement of building components stressed primarily in compression (Figure 4),
- anchoring of reinforcement to cover the envelope line of tensile force in the bending member (Figure 5).

The post-installed rebar connections may be used in the temperature range of -40 °C to $+80\text{ °C}$ (max short term temperature $+80\text{ °C}$ and max long term temperature $+50\text{ °C}$).

This European technical approval covers anchoring in bore holes made with hammer drilling or compressed air drilling. The post-installed rebar connection may be installed in dry or wet concrete. It must not be installed in flooded holes.

The provisions made in this European technical approval are based on an assumed working life of the post-installed rebar connection of 50 years. The indications given on the working life cannot be interpreted as a guarantee given by the producer, but are to be regarded only as a means for choosing the right products in relation to the expected economically reasonable working life of the works.

2 Characteristics of the product and methods of verification

2.1 Characteristics of the product

The post-installed rebar connection corresponds to the drawings and provisions given in Annexes 1 to 3. The characteristic material values, dimensions and tolerances not indicated in Annexes 1 to 3 shall correspond to the respective values laid down in the technical documentation⁷ of this European technical approval.

The two components of the injection adhesive are delivered in unmixed condition in coaxial cartridges of sizes 150 ml, 280 ml, 300 ml, 310 ml, 330 ml, 380 ml, 410 ml or 420 ml or in side-by-side cartridges of sizes 235 ml, 345 ml or 865 ml according to Annex 1. Each cartridge is marked with the identifying mark "Powers AC100-PRO" with the processing notes, charge code, shelf life, hazard code, curing time and processing time (depending on temperature).

The rebar shall comply with the specifications given in Annex 3.

2.2 Methods of verification

The assessment of fitness of the post-installed rebar connection for the intended use in relation to the requirements for mechanical resistance and stability and safety in use in the sense of the Essential Requirements 1 and 4 has been made in accordance with the "Guideline for European technical approval of Metal Anchors for Use in Concrete", Part 1 "Anchors in general" and Part 5 "Bonded anchors" and EOTA Technical Report TR 023 "Assessment of post-installed rebar connections"⁸.

In addition to the specific clauses relating to dangerous substances contained in this European technical approval, there may be other requirements applicable to the products falling within its scope (e.g. transposed European legislation and national laws, regulations and administrative provisions). In order to meet the provisions of the Construction Products Directive, these requirements need also to be complied with, when and where they apply.

3 Evaluation and attestation of conformity and CE marking

3.1 System of attestation of conformity

According to the Decision 96/582/EC of the European Commission⁹ system 2(i) (referred to as System 1) of the attestation of conformity applies.

This system of attestation of conformity is defined as follows:

System 1: Certification of the conformity of the product by an approved certification body on the basis of:

- (a) Tasks for the manufacturer:
 - (1) factory production control;
 - (2) further testing of samples taken at the factory by the manufacturer in accordance with a prescribed control plan;

⁷ The technical documentation of this European technical approval is deposited at the Deutsches Institut für Bautechnik and, as far as relevant for the tasks of the approved bodies involved in the attestation of conformity procedure, is handed over to the approved bodies.

⁸ The Technical Report TR 023 "Assessment of post-installed rebar connections" is published on EOTA website www.EOTA.eu.

⁹ Official Journal of the European Communities L 254 of 08.10.1996

- (b) Tasks for the approved body:
- (3) initial type-testing of the product;
 - (4) initial inspection of factory and of factory production control;
 - (5) continuous surveillance, assessment and approval of factory production control.

Note: Approved bodies are also referred to as "notified bodies".

3.2 Responsibilities

3.2.1 Tasks for the manufacturer

3.2.1.1 Factory production control

The manufacturer shall exercise permanent internal control of production. All the elements, requirements and provisions adopted by the manufacturer shall be documented in a systematic manner in the form of written policies and procedures, including records of results performed. This production control system shall insure that the product is in conformity with this European technical approval.

The manufacturer may only use initial/raw/constituent materials stated in the technical documentation of this European technical approval.

The factory production control shall be in accordance with the control plan which is part of the technical documentation of this European technical approval. The control plan is laid down in the context of the factory production control system operated by the manufacturer and deposited with Deutsches Institut für Bautechnik.¹⁰

The results of factory production control shall be recorded and evaluated in accordance with the provisions of the control plan.

3.2.1.2 Other tasks for the manufacturer

The manufacturer shall, on the basis of a contract, involve a body which is approved for the tasks referred to in section 3.1 in the field of anchors in order to undertake the actions laid down in section 3.2.2. For this purpose, the control plan referred to in sections 3.2.1.1 and 3.2.2 shall be handed over by the manufacturer to the approved body involved.

The manufacturer shall make a declaration of conformity, stating that the construction product is in conformity with the provisions of this European technical approval.

3.2.2 Tasks for the approved bodies

The approved body shall perform the

- initial type-testing of the product,
- initial inspection of factory and of factory production control,
- continuous surveillance, assessment and approval of factory production control,

in accordance with the provisions laid down in the control plan.

The approved body shall retain the essential points of its actions referred to above and state the results obtained and conclusions drawn in a written report.

The approved certification body involved by the manufacturer shall issue an EC certificate of conformity of the product stating the conformity with the provisions of this European technical approval.

In cases where the provisions of the European technical approval and its control plan are no longer fulfilled the certification body shall withdraw the certificate of conformity and inform Deutsches Institut für Bautechnik without delay.

¹⁰ The control plan is a confidential part of the European technical approval and only handed over to the approved body involved in the procedure of attestation of conformity. See section 3.2.2.

3.3 CE marking

The CE marking shall be affixed on each packaging of the injection mortar. The letters "CE" shall be followed by the identification number of the approved certification body, where relevant, and be accompanied by the following additional information:

- the name and address of the holder of the approval (legal entity responsible for the manufacture),
- the last two digits of the year in which the CE marking was affixed,
- the number of the EC certificate of conformity for the product,
- the number of the European technical approval,
- the number of the guideline for European technical approval.

4 Assumptions under which the fitness of the product for the intended use was favourably assessed

4.1 Manufacturing

The European technical approval is issued for the product on the basis of agreed data/information, deposited with Deutsches Institut für Bautechnik, which identifies the product that has been assessed and judged. Changes to the product or production process, which could result in this deposited data/information being incorrect, should be notified to Deutsches Institut für Bautechnik before the changes are introduced. Deutsches Institut für Bautechnik will decide whether or not such changes affect the approval and consequently the validity of the CE marking on the basis of the approval and if so whether further assessment or alterations to the approval shall be necessary.

4.2 Drafting

Rebar connections must be designed in keeping with good engineering practice. Considering the loads to be anchored, design calculations and design drawings must be produced which can be checked. At least the following items must be stated in the design drawings:

- grade of concrete strength,
- diameter, drilling technique, concrete cover, spacing and embedment depth of the rebar,
- length l_v and length for markings l_m on the injection extension according to Annex 8,
- use of a guide device (drilling aid) for drilling holes close to edges (if necessary),
- kind of preparation of the joint between building component being connected including the diameter and thickness of concrete layer that has to be removed.

4.3 Design

4.3.1 General

The actual position of the reinforcement in the existing structure shall be determined on the basis of the construction documentation and taken into account when designing.

The design of post-installed rebar connections according to Annex 2 and determination of the internal section forces to be transferred in the construction joint shall be verified in accordance with EN 1992-1-1:2004. When ascertaining the tensile force in the rebar, allowance shall be made for the statically effective height of the bonded-in reinforcement.

The verification of the immediate local force transfer to the concrete has been provided.

The verification of the transfer of the loads to be anchored to the building component shall be provided.

The spacing between post-installed rebars shall be greater than the minimum of $5 d_s$ and 50 mm (see Annex 4).

4.3.2 Determination of the basic anchorage length

The required basic anchorage length $l_{b,rqd}$ shall be determined in accordance with EN 1992-1-1, Section 8.4.3:

$$l_{b,rqd} = (d_s / 4) (\sigma_{sd} / f_{bd})$$

with: d_s = diameter of the rebar

σ_{sd} = calculated design stress of the rebar

f_{bd} = design value of bond strength according to Annex 5, Table 4
in consideration of the coefficient related to the quality of bond conditions and of the coefficient related to the bar diameter and of the drilling technique

4.3.3 Determination of the design anchorage length

The required design anchorage length l_{bd} shall be determined in accordance with EN 1992-1-1, Section 8.4.4:

$$l_{bd} = \alpha_1 \cdot \alpha_2 \cdot \alpha_3 \cdot \alpha_4 \cdot \alpha_5 \cdot l_{b,rqd} \geq l_{b,min}$$

with: $l_{b,rqd}$ = according to section 4.3.2

α_1 = 1.0 for straight bars

α_2 = 0.7...1.0 calculated acc. to EN 1992-1-1, Table 8.2

α_3 = 1.0 because of no transverse reinforcement

α_4 = 1.0 because of no welded transverse reinforcement

α_5 = 0.7...1.0 for influence of transverse pressure acc. to EN 1992-1-1, Table 8.2

$l_{b,min}$ = minimum anchorage length acc. to EN 1992-1-1

= max {0.3 $l_{b,rqd}$; 10 d_s ; 100 mm} under tension

= max {0.6 $l_{b,rqd}$; 10 d_s ; 100 mm} under compression

The maximum permissible embedment depth is given in Annex 5 depending on diameter of the rebar.

4.3.4 Overlap joints

The required design lap length l_0 shall be determined in accordance with EN 1992-1-1, Section 8.7.3:

$$l_0 = \alpha_1 \cdot \alpha_2 \cdot \alpha_3 \cdot \alpha_5 \cdot \alpha_6 \cdot l_{b,rqd} \geq l_{0,min}$$

with: $l_{b,rqd}$ = according to Section 4.3.2

α_1 = 1.0 for straight bars

α_2 = 0.7...1.0 calculated acc. to EN 1992-1-1, Table 8.2

α_3 = 1.0 because of no transverse reinforcement

α_5 = 0.7...1.0 for influence of transverse pressure acc. to EN 1992-1-1, Table 8.2

α_6 = 1.0...1.5 for influence of percentage of lapped bars relative to the total cross-section area acc. to EN 1992-1-1, Table 8.3

$l_{0,min}$ = minimum lap length acc. to EN 1992-1-1

= max {0.3 α_6 $l_{b,rqd}$; 15 d_s ; 200 mm}

The maximum permissible embedment depth is given in Annex 5 depending on diameter of the rebar.

4.3.5 Embedment depth for overlap joints

For calculation of the effective embedment depth of overlap joints the concrete cover at end-face of bonded-in rebar c_1 shall be considered (see Annex 4, Figure 7):

$$l_v \geq l_0 + c_1$$

with: l_0 = required lap length acc. to Section 4.3.4 and to EN 1992-1-1

c_1 = concrete cover at end-face of bonded-in rebar (see Annex 4, Figure 7)

If the clear distance between the overlapping rebars is greater than $4 d_s$ the lap length shall be enlarged by the difference between the clear distance and $4 d_s$.

4.3.6 Concrete cover

The concrete cover required for bonded-in rebars is shown in Annex 5, Table 2, in relation to the drilling method and the hole tolerance.

Furthermore the minimum concrete cover given in EN 1992-1-1, Section 4.4.1.2 shall be observed.

4.3.7 Transverse reinforcement

The requirements of transverse reinforcement in the area of the post-installed rebar connection shall comply with EN 1992-1-1, Section 8.7.4.

4.3.8 Connection joint

The transfer of shear forces between new concrete and existing structure shall be designed according to EN 1992-1-1. The joints for concreting must be roughened to at least such an extent that aggregate protrude.

In case of a carbonated surface of the existing concrete structure the carbonated layer shall be removed in the area of the post-installed rebar connection with a diameter of $d_s + 60$ mm prior to the installation of the new rebar.

The depth of concrete to be removed shall correspond to at least the minimum concrete cover for the respective environmental conditions in accordance with EN 1992-1-1.

The foregoing may be neglected if building components are new and not carbonated and if building components are in dry conditions.

4.4 Installation

The fitness for use of the post-installed rebar connection can only be assumed if the rebar is installed as follows:

- the installation of post-installed rebar shall be done only by suitable trained installer and under supervision on site; the conditions under which an installer may be considered as suitable trained and the conditions for supervision on site are up to the Member States in which the installation is done,
- use of the injection system only as supplied by the manufacturer without exchanging the components of the Injection system,
- installation in accordance with the manufacturer's specifications and drawings using the tools indicated in the technical documentation of this European technical approval,
- checks before rebar installation to ensure that the strength class of the concrete in which the post-installed rebar connection is to be placed is in the range given and is not lower than that of the concrete to which the characteristic loads apply,
- check of concrete being well compacted, e.g. without significant voids,
- check the position of the existing rebars (if the position of existing rebars is not known, it shall be determined using a rebar detector suitable for this purpose as well as on the basis of the construction documentation and then marked on the building component for the overlap joint),

- keeping the anchorage depth as specified in the design drawings,
- keeping of concrete cover and spacing as specified in the design drawings,
- positioning of the drill holes without damaging the reinforcement,
- in case of aborted drill hole the drill hole shall be filled with mortar,
- the post-installed rebar connection must not be installed in flooded holes,
- the drilling and cleaning of the hole and the installation shall be performed only with the equipment specified by the manufacturer according to the manufacturer's installation instructions (see Annexes 6 to 10), it shall be ensured that this equipment is available on site and it is used,
- during curing of the injection mortar the temperature of the building component must not be less than -10 °C and no more than $+40\text{ °C}$; observing the curing time given in Annex 9.

5 Recommendations concerning packaging, transport and storage

5.1 Responsibility of the manufacturer

It is in the responsibility of the manufacturer to ensure that the information on the specific conditions according to sections 1 and 2 including Annexes referred to as well as sections 4 and 5.2 is given to those who are concerned. This information may be made by reproduction of the respective parts of the European technical approval. In addition all installation data shall be shown clearly on the package and/or on an enclosed instruction sheet, preferably using illustration(s).

The minimum data required are:

- drill bit diameter,
- diameter of rebar,
- admissible service temperature range,
- curing time of the injection mortar,
- Installation instructions including cleaning of the drill hole,
- reference to any special installation equipment needed,
- identification of the manufacturing batch,

All data shall be presented in a clear and explicit form.

5.2 Packaging, transport and storage

The mortar cartridges shall be protected against sun radiation and shall be stored according to the manufacture's installation instructions in dry condition at temperatures of at least $+5\text{ °C}$ to not more than $+25\text{ °C}$.

Mortar cartridges with expired shelf life must no longer be used.

Uwe Bender
Head of Department

beglaubigt:
Baderschneider

Product description and intended use

Covered are only post-installed rebar connections in non-carbonated concrete (concrete C12/15 – C50/60 according to EN 206-1:2000) on the assumption only that the design of post-installed rebar connections is done in accordance to EN 1992-1-1:2004.

- Installation in dry or wet concrete, it must not be installed in flooded holes.
- Maximum short term temperature +80°C and max. long term temperature +50°C
- Reinforcing bar \varnothing 8 mm to 25 mm with properties of class B and C according to Annex 3
- Maximum embedment depth see Annex 5, Table 3

Powers Injection system AC100-PRO:

Dispensing tools: see Annex 10, Table 8

Brush:

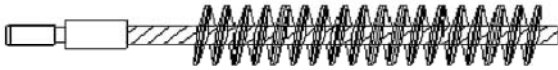

Brush extension:



SDS Plus Adapter:



Hand-pump:



Hand slide valve with air hose:



Injection mortar: Powers AC100-PRO

Typ "coaxial": 150 ml, 280 ml, 300 ml, 310ml, 330 ml, 380 ml, 410 ml und 420 ml Kartusche



Imprint: Powers AC100-PRO, processing notes, charge-code, shelf life, hazard-code, curing- and processing time (depending on the temperature), with as well as without travel scale

Type "side-by-side": 235 ml, 345 ml and 825 ml cartridge

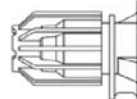

Imprint: Powers AC100-PRO, processing notes, charge-code, shelf life, hazard-code, curing- and processing time (depending on the temperature), with as well as without travel scale

Static Mixer

CRW 14W

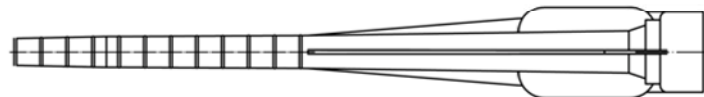

TAH 18W



Piston plug and mixer extension

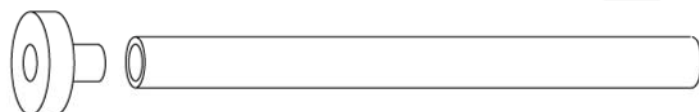

Powers Injection system AC100-PRO for rebar connection

Product description and Intended use

Annex 1

Figure 1: Overlapping joint for rebar connections of slabs and beams

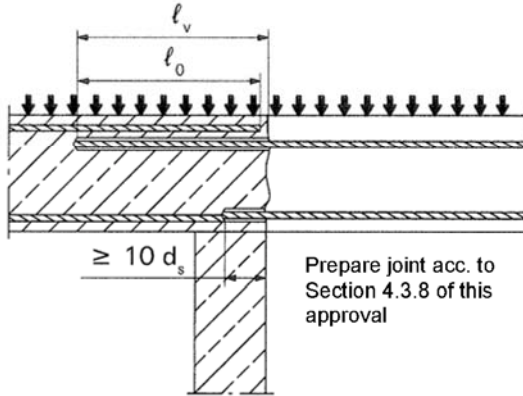

Figure 2: Overlapping joint at a foundation of a wall or column where the rebars are stressed in tension

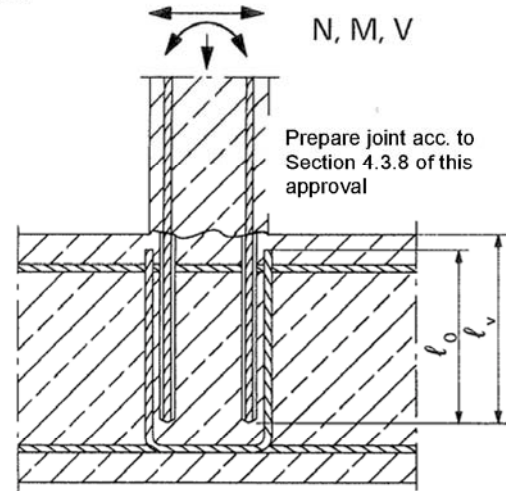

Figure 3: End anchoring of slabs or beams, designed as simply supported

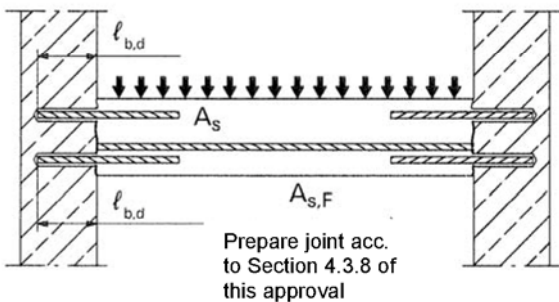

Figure 4: Rebar connection for components stressed primarily in compression. The rebars are stressed in compression

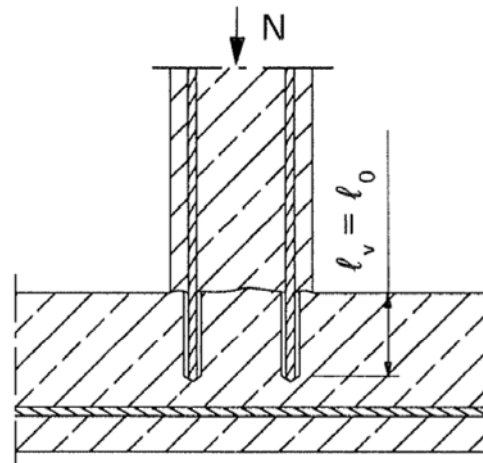
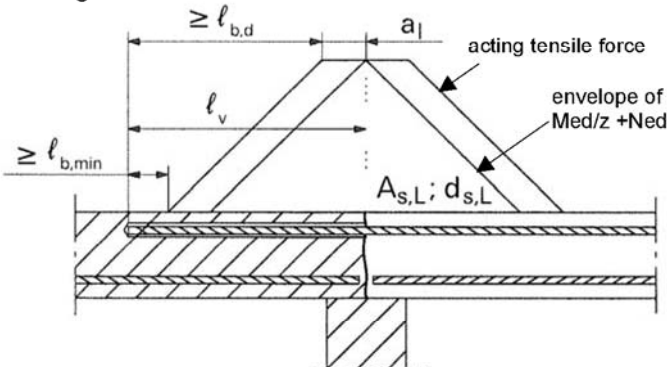

Figure 5: Anchoring of reinforcement to cover the line of acting tensile force



Note to Figure 1 to 5:

In the figures no transverse reinforcement is plotted, the transverse reinforcement as required by EN 1992-1-1 shall be present.

The shear transfer between old and new concrete shall be designed according to EN 1992-1-1

General rules for construction and design compare Annex 4.

Powers Injection system AC100-PRO for rebar connection

Examples of use for rebars

Annex 2

Figure 6: Properties of reinforcement

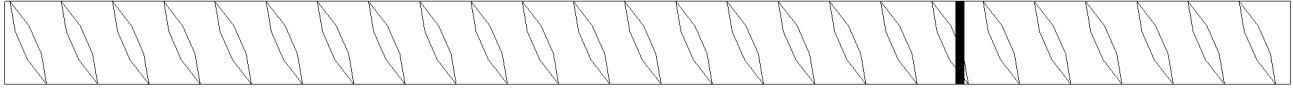

Table 1a: Abstract of EN 1992-1-1 Annex C, Table C.1, Properties of reinforcement

| Product form | | Bars and de-coiled rods | |
|---|-----------------------|-------------------------|-----------------------|
| Class | | B | C |
| Characteristic yield strength f_{yk} or $f_{0,2k}$ (N/mm ²) | | 400 to 600 | |
| Minimum value of $k = (f_t / f_y)_k$ | | $\geq 1,08$ | $\geq 1,15$ < 1,35 |
| Characteristic strain at maximum force ϵ_{uk} (%) | | $\geq 5,0$ | $\geq 7,5$ |
| Bendability | | Bend/Rebend test | |
| Maximum deviation from nominal mass (individual bar) (%) | Nominal bar size (mm) | | |
| | ≤ 8 | $\pm 6,0$ | |
| | > 8 | $\pm 4,5$ | |

Table 1b: Abstract of EN 1992-1-1 Annex C, Table C.2N, Properties of reinforcement

| Product form | | Bars and de-coiled rods | |
|---|------------------------------------|-------------------------|---|
| Class | | B | C |
| Min. value of related rip area (according EN 15630) $f_{R,min}$ | nominal diameter of the rebar (mm) | | |
| | 8 to 12 | 0,040 | |
| | > 12 | 0,056 | |

Rip height of the bar shall be in the range $0,05d \leq h \leq 0,07d$
(d: Nominal diameter of the bar; h: Rip height of the bar)

Powers Injection system AC100-PRO for rebar connection

Properties of reinforcement

Annex 3

Figure 7: General design rules of construction for bended-in rebars

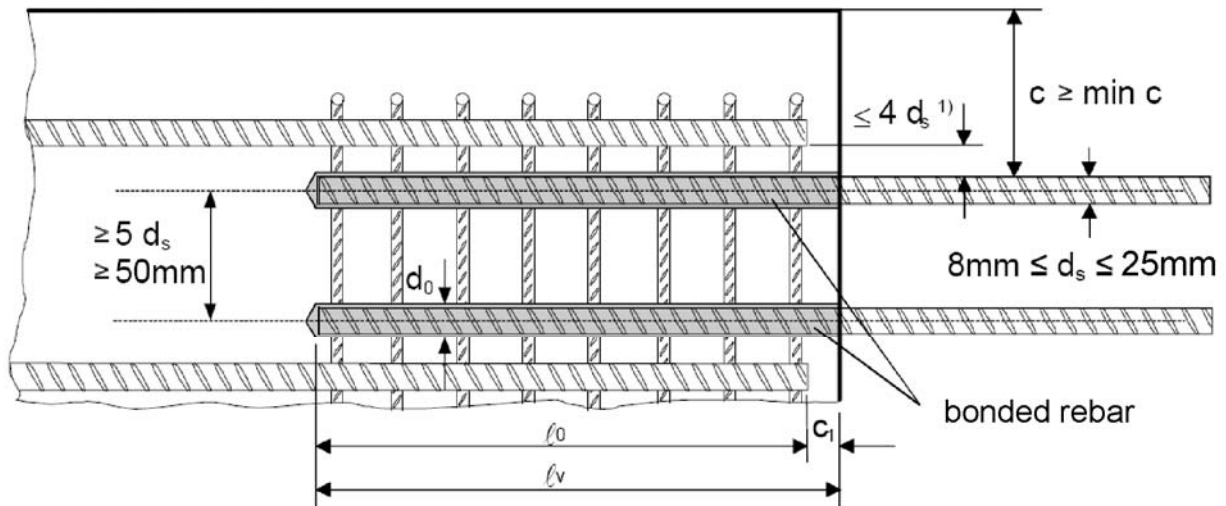

- 1) If the clear distance between lapped bars exceeds $4d_s$, then the lap length shall be increased by the difference between the clear bar distance and $4d_s$.

The following applies to Figure 7:

- l_v or l_0 are in accordance with section 4.3.4 and 4.3.5 of the approval
- The provision of sufficient transverse reinforcement according to section 4.3.7 of this approval

| | |
|-------|---|
| c | concrete cover post installed rebar |
| c_1 | concrete cover at end-face of bond-in bar |
| min c | minimum concrete cover according to Annex 5 |
| d_s | diameter bonded-in bar |
| l_0 | lap length |
| l_v | effective embedment depth |
| d_0 | normal drill bit diameter, see Annex 7 |

Table 2: Minimum concrete cover min c of bonded-in rebar depending of drilling method

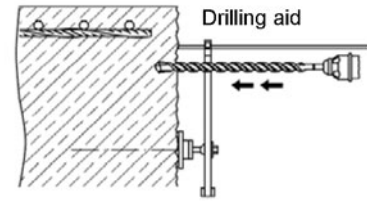

| Drilling method | Rebar diameter | Without drilling aid | With drilling aid |
|-------------------------|----------------|---|---|
| Hammer drilling | < 25 mm | $30 \text{ mm} + 0,06 \cdot l_v \geq 2 d_s$ | $30 \text{ mm} + 0,02 \cdot l_v \geq 2 d_s$ |
| | = 25 mm | $40 \text{ mm} + 0,06 \cdot l_v \geq 2 d_s$ | $40 \text{ mm} + 0,02 \cdot l_v \geq 2 d_s$ |
| Compressed air drilling | < 25 mm | $50 \text{ mm} + 0,08 \cdot l_v$ | $50 \text{ mm} + 0,02 \cdot l_v$ |
| | = 25 mm | $60 \text{ mm} + 0,08 \cdot l_v$ | $60 \text{ mm} + 0,02 \cdot l_v$ |

The minimum concrete cover must be observed according EN 1992-1-1:2004

Table 3: Minimum anchorage length¹⁾ and lap splice length for C20/25 and maximum installation length l_{max}

| Rebar | | $l_{b,min}$ [mm] | $l_{o,min}$ [mm] | l_{max} [mm] |
|-------------------|--------------------------------|------------------|------------------|----------------|
| $\varnothing d_s$ | $f_{y,k}$ [N/mm ²] | | | |
| 8 mm | 500 | 113 | 200 | 1000 |
| 10 mm | 500 | 142 | 200 | 1000 |
| 12 mm | 500 | 170 | 200 | 1200 |
| 14 mm | 500 | 198 | 210 | 1400 |
| 16 mm | 500 | 227 | 240 | 1600 |
| 20 mm | 500 | 284 | 300 | 2000 |
| 22 mm | 500 | 312 | 330 | 2000 |
| 24 mm | 500 | 340 | 360 | 2000 |
| 25 mm | 500 | 354 | 375 | 2000 |

¹⁾ according to EN 1992-1-1:2004: $l_{b,min}$ (8.6) and $l_{o,min}$ (8.11) for good bond conditions and $a_b = 1,0$ with maximum yield stress for rebar B500 B and $\gamma_M = 1,15$

Table 4: Design values of the ultimate bond resistance f_{bd} ¹⁾ in N/mm² for all drilling methods for good conditions

| Rebar - \varnothing | Concrete class | | | | | | | | |
|-----------------------|----------------|--------|--------|--------|--------|--------|--------|--------|--------|
| | C12/15 | C16/20 | C20/25 | C25/30 | C30/37 | C35/45 | C40/50 | C45/55 | C50/60 |
| 8 to 25 mm | 1,6 | 2,0 | 2,3 | 2,7 | 3,0 | 3,4 | 3,7 | 4,0 | 4,3 |

¹⁾ Tabulated values for f_{bd} are valid for good bond condition according to EN 1992-1-1:2004. For all other bond conditions multiply the values for f_{bd} by 0,7.

Powers Injection system AC100-PRO for rebar connection

Installation parameters and design values of ultimate bond resistance f_{bd}

Annex 5

A) Bore hole drilling

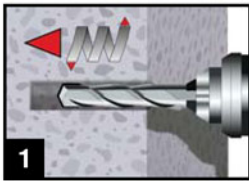

1. Drill a hole into the base material to the size and embedment depth required by the selected reinforcing bar with carbide hammer drill (HD) or a compressed air drill (CD).



Hammer drill (HD)

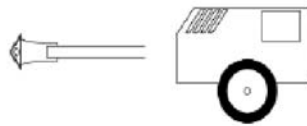

Compressed air drill (CD)

| Rebar - \varnothing d_s | Drill - \varnothing [mm] |
|--------------------------------|-------------------------------|
| 8 mm | 12 |
| 10 mm | 14 |
| 12 mm | 16 |
| 14 mm | 18 |
| 16 mm | 20 |
| 20 mm | 25 |
| 22 mm | 28 |
| 24 mm | 32 |
| 25 mm | 32 |

B) Bore hole cleaning

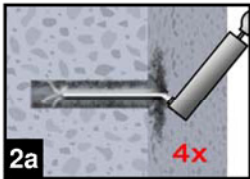

or

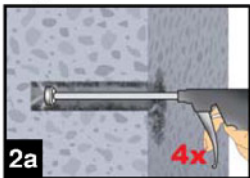

- 2a. Starting from the bottom or back of the bore hole, blow the hole clean with compressed air (min. 6 bar) or a hand pump a minimum of four times. If the bore hole ground is not reached an extension shall be used.

For bore holes deeper than 240 mm, compressed air (min. 6 bar) **must** be used.

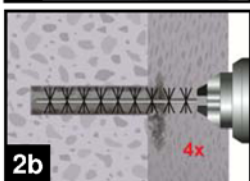

- 2b. Check brush diameter (Table 5) and attach the brush to a drilling machine or a battery screwdriver. Brush the hole with an appropriate sized wire brush $> d_{b,min}$ (Table 5) a minimum of four times. If the bore hole ground is not reached with the brush, a brush extension shall be used.

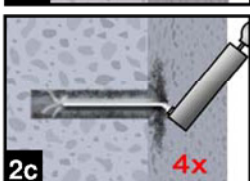

or



- 2c. Finally blow the hole clean again with compressed air (min. 6 bar) or a hand pump a minimum of four times. If the bore hole ground is not reached an extension shall be used.

For bore holes deeper than 240 mm, compressed air (min. 6 bar) **must** be used.

Powers Injection system AC100-PRO for rebar connection

Installation instruction
Bore hole drilling
Bore hole cleaning

Annex 6

Table 5: Cleaning tools

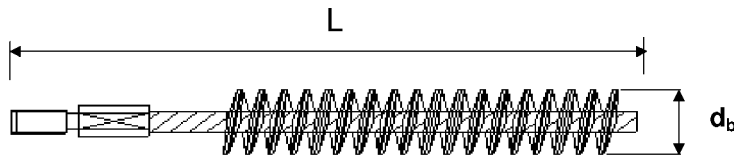

| d_s Rebar - \varnothing | d_0 Drill bit - \varnothing | d_b Brush - \varnothing | $d_{b,min}$ min. Brush - \varnothing | L Total length |
|--------------------------------|------------------------------------|--------------------------------|--|-------------------|
| (mm) | (mm) | (mm) | (mm) | (mm) |
| 8 | 12 | 14 | 12,5 | 170 |
| 10 | 14 | 16 | 14,5 | 200 |
| 12 | 16 | 18 | 16,5 | 200 |
| 14 | 18 | 20 | 18,5 | 300 |
| 16 | 20 | 22 | 20,5 | 300 |
| 20 | 25 | 27 | 25,5 | 300 |
| 22 | 28 | 30 | 28,5 | 300 |
| 24 | 32 | 34 | 32,5 | 300 |
| 25 | 32 | 34 | 32,5 | 300 |



Hand pump (volume 750 ml)

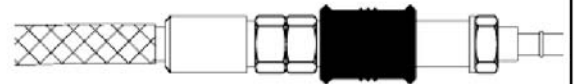

Rec. compressed air tool
hand slide valve (min 6 bar)

C) Preparation of bar and cartridge

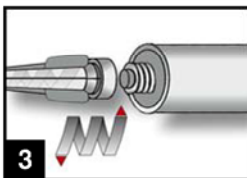

3. Attach the supplied static-mixing nozzle to the cartridge and load the cartridge into the correct dispensing tool.
For every working interruption longer than the recommended working time (Table 7) as well as for every new cartridges, a new static-mixer shall be used.

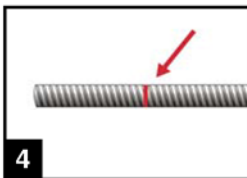

4. Prior to inserting the reinforcing bar into the filled bore hole, the position of the embedment depth shall be marked (e.g. with tape) on the reinforcing bar and insert bar in empty hole to verify hole and depth l_v .
The anchor should be free of dirt, grease, oil or other foreign material.

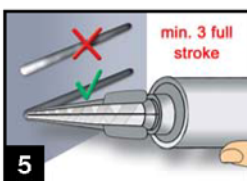

5. Prior to dispensing into the anchor hole, squeeze out separately the mortar until it shows a consistent grey colour, but a minimum of three full strokes, and discard non-uniformly mixed adhesive components.

Powers Injection system AC100-PRO for rebar connection

Installation instruction
Cleaning tools
Preparation of bar and cartridge

Annex 7

D) Filling the bore hole

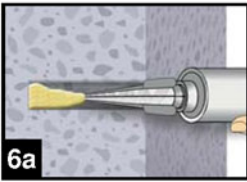

6. Starting from the bottom or back of the cleaned anchor hole fill the hole up to approximately two-thirds with adhesive. Slowly withdraw the static mixing nozzle as the hole fills to avoid creating air pockets. For embedment larger than 190 mm an extension nozzle shall be used.

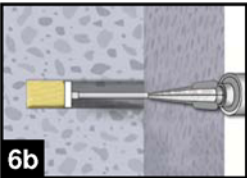

For overhead and horizontal installation and bore holes deeper than 240 mm a piston plug and the appropriate mixer extension must be used.

Observe the gel-/ working times given in Table 7.

Table 6: Piston plugs, max anchorage depth and mixer extension

| Bar size | Drill bit - Ø | | Piston plug | Cartridge: All sizes | | | | Cartridge: side-by-side (825 ml) | |
|----------|---------------|----|-------------|-------------------------|-----------------|----------------|-----------------|-------------------------------------|-----------------|
| | HD | PD | | Hand or battery tool | | Pneumatic tool | | Pneumatic tool | |
| | | | | l_{max} | Mixer extension | l_{max} | Mixer extension | l_{max} | Mixer extension |
| (mm) | (mm) | | No. | (cm) | | (cm) | | (cm) | |
| 8 | 12 | - | - | 70 | VL 10/0,75 | 80 | VL 10/0,75 | 80 | VL 10/0,75 |
| 10 | 14 | - | #14 | | | 100 | | 100 | |
| 12 | 16 | | #16 | | | 120 | | 200 | |
| 14 | 18 | | #18 | | | 140 | | | |
| 16 | 20 | | #20 | | | 160 | | | |
| 20 | 25 | 26 | #25 | 50 | VL 16/1,8 | 70 | 200 | VL 16/1,8 | |
| 22 | 28 | | #28 | | | 50 | | | |
| 24 | 32 | | #32 | | | | | | |
| 25 | 32 | | #32 | | | | | | |

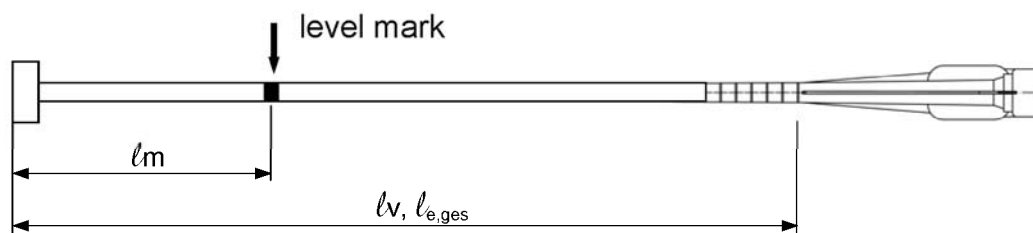

Injection tool must be marked by mortar level mark l_m and anchorage depth l_v resp. $l_{e,ges}$ with tape or marker.

Quick estimation: $l_m = 1/3 \cdot l_v$

Continue injection until the mortar level mark l_m becomes visible.

Optimum mortar volume: $l_m = l_v$ resp. $l_{e,ges} \cdot \left(1,2 \cdot \frac{d_s^2}{d_0^2} - 0,2 \right)$ [mm]

Powers Injection system AC100-PRO for rebar connection

Installation instruction

Filling the bore hole

Annex 8

E) Inserting the rebar

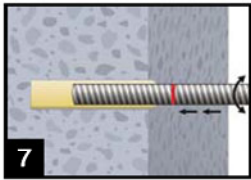

7. Push the reinforcing bar into the anchor hole while turning slightly to ensure positive distribution of the adhesive until the embedment depth is reached.

The bar should be free of dirt, grease, oil or other foreign material.

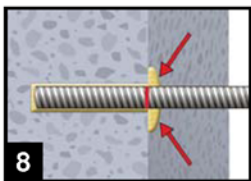

8. Be sure that the bar is inserted in the bore hole until the embedment mark is at the concrete surface and that excess mortar is visible at the top of the hole. If these requirements are not maintained, the application has to be renewed. For overhead installation fix embedded part (e.g. wedges).

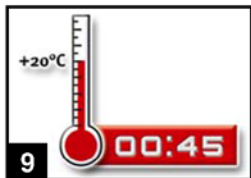

9. Observe gelling time t_{gel} . Attend that the gelling time can vary according to the base material temperature (see Table 7). It is not allowed to move the bar after gelling time t_{gel} has elapsed.

Allow the adhesive to cure to the specified time prior to applying any load. Do not move or load the bar until it is fully cured (attend Table 7). After full curing time t_{cure} has elapsed, the add-on part can be installed.

Table 7: Base material temperature, gelling time and curing time

| Concrete temperature | Gelling- / working time ¹⁾ | Minimum curing time in dry concrete ⁵⁾ |
|----------------------|---------------------------------------|---|
| | t_{gel} | $t_{cure,dry}$ |
| -10°C bis -6°C | 90 min ²⁾ | 24 h |
| -5°C bis -1°C | 90 min ³⁾ | 14 h |
| 0°C bis +4°C | 45 min ³⁾ | 7 h |
| +5°C bis +9°C | 25 min ³⁾ | 2 h |
| +10°C bis +19°C | 15 min ³⁾ | 80 min |
| +20°C bis +24°C | 6 min ³⁾ | 45 min |
| +25°C bis +29°C | 4 min ³⁾ | 25 min |
| +30°C bis +40°C | 2,5 min ⁴⁾ | 15 min |

¹⁾ t_{gel} : maximum time from starting of mortar injection to completing of rebar setting.

²⁾ Cartridge temperature **must** be at minimum +15°C

³⁾ Cartridge temperature **must** be between +5°C and +25°C

⁴⁾ Cartridge temperature **must** be below +20°C









⁵⁾ In wet concrete the curing time $t_{cure,dry}$ has to be doubled up

Powers Injection system AC100-PRO for rebar connection

Installation instruction
Inserting rebar
Gelling time and curing time

Annex 9

Table 8: Dispensing tools

| Cartridge type/size | Hand tool | | Pneumatic tool |
|---|---|--|---|
| Coaxial cartridges 150, 280, 300, 310, 330 ml |  e.g. Type H 297 or H244C | |  e.g. Type TS 492 X |
| Coaxial cartridges 380, 410, 420 ml |  e.g. Type CCM 380/10 |  e.g. Type H 285 or H244C |  e.g. Type TS 485 LX |
| Side-by-side cartridges 235, 345 ml |  e.g. Type CBM 330A |  e.g. Type H 260 |  e.g. Type TS 477 LX |
| Side-by-side cartridge 825 ml | - | - |  e.g. Type TS 498X |

All cartridges could also be extruded by a battery tool.

Powers Injection system AC100-PRO for rebar connection

Dispensing tools

Annex 10

Table 9: Values for pre-calculation of anchoring.
Example for: C20/25; good bond condition; Rebar yield strength 500 N/mm²

| Bar-Ø d _s | α ₁ =α ₂ =α ₃ =α ₄ =α ₅ =1,0 | | | α ₂ or α ₅ =0,7; α ₁ =α ₃ =α ₄ =1,0 | | |
|-------------------------|---|------------------------------|---------------|--|------------------------------|---------------|
| | Anchorage length l _{bd} | Design value N _{Rd} | Mortar volume | Anchorage length l _{bd} | Design value N _{Rd} | Mortar volume |
| [mm] | [mm] | [kN] | [ml] | [mm] | [kN] | [ml] |
| 8 | 113* | 6,53 | 9 | 113* | 9,33 | 9 |
| | 180 | 10,40 | 14 | 150 | 12,39 | 11 |
| | 250 | 14,45 | 19 | 190 | 15,69 | 14 |
| | 378 | 21,85 | 29 | 265 | 21,88 | 20 |
| 10 | 142* | 10,26 | 13 | 142* | 14,66 | 13 |
| | 220 | 15,90 | 20 | 190 | 19,61 | 17 |
| | 310 | 22,40 | 28 | 240 | 24,77 | 22 |
| | 390 | 28,18 | 35 | 280 | 28,90 | 25 |
| | 473 | 34,18 | 43 | 331 | 34,17 | 30 |
| 12 | 170* | 14,74 | 18 | 170* | 21,06 | 18 |
| | 270 | 23,41 | 29 | 230 | 28,49 | 24 |
| | 370 | 32,08 | 39 | 280 | 34,68 | 30 |
| | 470 | 40,75 | 50 | 340 | 42,12 | 36 |
| | 567 | 49,16 | 60 | 397 | 49,18 | 42 |
| 14 | 198* | 20,03 | 24 | 198* | 28,61 | 24 |
| | 310 | 31,36 | 37 | 260 | 37,57 | 31 |
| | 430 | 43,50 | 52 | 330 | 47,69 | 40 |
| | 550 | 55,64 | 66 | 400 | 57,81 | 48 |
| | 662 | 66,97 | 80 | 463 | 66,91 | 56 |
| 16 | 227* | 26,24 | 31 | 227* | 37,49 | 31 |
| | 360 | 41,62 | 49 | 300 | 49,55 | 41 |
| | 490 | 56,65 | 67 | 380 | 62,76 | 52 |
| | 620 | 71,68 | 84 | 450 | 74,32 | 61 |
| | 756 | 87,40 | 103 | 529 | 87,37 | 72 |
| 20 | 284* | 41,04 | 60 | 284* | 58,63 | 60 |
| | 450 | 65,03 | 95 | 380 | 78,45 | 81 |
| | 610 | 88,15 | 129 | 470 | 97,03 | 100 |
| | 780 | 112,72 | 165 | 570 | 117,68 | 121 |
| | 945 | 136,57 | 200 | 662 | 136,67 | 140 |
| 22 | 312* | 49,60 | 88 | 312* | 70,85 | 88 |
| | 490 | 77,89 | 139 | 420 | 95,38 | 119 |
| | 680 | 108,10 | 192 | 520 | 118,09 | 147 |
| | 860 | 136,71 | 243 | 620 | 140,80 | 175 |
| | 1040 | 165,32 | 294 | 728 | 165,32 | 206 |
| 24 | 340* | 58,96 | 144 | 340* | 84,23 | 144 |
| | 540 | 93,64 | 228 | 450 | 111,48 | 190 |
| | 740 | 128,33 | 312 | 570 | 141,21 | 241 |
| | 940 | 163,01 | 397 | 680 | 168,46 | 287 |
| | 1134 | 196,65 | 479 | 794 | 196,70 | 335 |
| 25 | 354* | 63,95 | 133 | 354* | 91,35 | 133 |
| | 560 | 101,16 | 211 | 470 | 121,29 | 177 |
| | 770 | 139,09 | 290 | 590 | 152,26 | 222 |
| | 970 | 175,22 | 365 | 710 | 183,22 | 267 |
| | 1181 | 213,34 | 444 | 827 | 213,42 | 311 |

* minimum anchorage length, see also Annex 5 Table 3; The design value is valid for "good bond conditions" according to EN 1992-1-1. All other condition: multiply value by 0,7. Mortar volume based on equation:

$$V = 1,2 \cdot (d_0^2 - d_s^2) \cdot \pi \cdot l_b / 4$$

Powers Injection system AC100-PRO for rebar connection

Values for pre-calculation of anchoring.
Example for:
C20/25; good bond condition; Rebar yield strength 500 N/mm²

Annex 11

Table 10: Values for pre-calculation of overlap joints.
Example for: C20/25; good bond condition; Rebar yield strength 500 N/mm²

| Bar- \varnothing d_s | $\alpha_1=\alpha_2=\alpha_3=\alpha_4=\alpha_5=1,0$ | | | α_2 or $\alpha_5=0,7$; $\alpha_1=\alpha_3=\alpha_4=1,0$ | | |
|-----------------------------|--|-----------------------|---------------|---|-----------------------|---------------|
| | Lap length l_0 | Design value N_{Rd} | Mortar volume | Lap length l_0 | Design value N_{Rd} | Mortar volume |
| [mm] | [mm] | [kN] | [ml] | [mm] | [kN] | [ml] |
| 8 | 200* | 11,56 | 15 | 200* | 16,52 | 15 |
| | 240 | 13,87 | 18 | 220 | 18,17 | 17 |
| | 290 | 16,76 | 22 | 230 | 18,99 | 17 |
| | 378 | 21,85 | 29 | 265 | 21,88 | 20 |
| 10 | 200* | 14,45 | 18 | 200* | 20,64 | 18 |
| | 270 | 19,51 | 24 | 230 | 23,74 | 21 |
| | 340 | 24,57 | 31 | 270 | 27,87 | 24 |
| | 400 | 28,90 | 36 | 300 | 30,97 | 27 |
| 12 | 473* | 34,18 | 43 | 331* | 34,17 | 30 |
| | 200* | 17,34 | 21 | 200* | 24,77 | 21 |
| | 290 | 25,15 | 31 | 250 | 30,97 | 26 |
| | 380 | 32,95 | 40 | 300 | 37,16 | 32 |
| 14 | 480 | 41,62 | 51 | 350 | 43,35 | 37 |
| | 567 | 49,16 | 60 | 397 | 49,18 | 42 |
| | 210* | 21,24 | 25 | 210* | 30,35 | 25 |
| | 320 | 32,37 | 39 | 270 | 39,02 | 33 |
| 16 | 440 | 44,51 | 53 | 340 | 49,13 | 41 |
| | 550 | 55,64 | 66 | 400 | 57,81 | 48 |
| | 662 | 66,97 | 80 | 463 | 66,91 | 56 |
| | 240* | 27,75 | 33 | 240* | 39,64 | 33 |
| 20 | 370 | 42,78 | 50 | 310 | 51,20 | 42 |
| | 500 | 57,81 | 68 | 380 | 62,76 | 52 |
| | 630 | 72,83 | 86 | 460 | 75,97 | 62 |
| | 756 | 87,40 | 103 | 529 | 87,37 | 72 |
| 22 | 300* | 43,35 | 64 | 300* | 61,93 | 64 |
| | 460 | 66,48 | 98 | 390 | 80,51 | 83 |
| | 620 | 89,60 | 131 | 480 | 99,09 | 102 |
| | 780 | 112,72 | 165 | 570 | 117,68 | 121 |
| 24 | 945 | 136,57 | 200 | 662 | 136,67 | 140 |
| | 330* | 52,46 | 93 | 330* | 74,94 | 93 |
| | 510 | 81,07 | 144 | 430 | 97,65 | 122 |
| | 680 | 108,10 | 192 | 530 | 120,36 | 150 |
| 25 | 860 | 136,71 | 243 | 630 | 143,07 | 178 |
| | 1040 | 165,32 | 294 | 728 | 165,32 | 206 |
| | 360* | 62,43 | 152 | 360* | 89,19 | 152 |
| | 550 | 95,38 | 232 | 470 | 116,44 | 198 |
| 25 | 750 | 130,06 | 317 | 580 | 143,69 | 245 |
| | 940 | 163,01 | 397 | 690 | 170,94 | 291 |
| | 1134 | 196,65 | 479 | 794 | 196,70 | 335 |
| | 375* | 67,74 | 141 | 375* | 96,77 | 141 |
| 25 | 580 | 104,77 | 218 | 490 | 126,45 | 184 |
| | 780 | 140,90 | 293 | 600 | 154,84 | 226 |
| | 980 | 177,03 | 369 | 710 | 183,22 | 267 |
| | 1181 | 213,34 | 444 | 827 | 213,42 | 311 |

* minimum anchorage length, see also Annex 5 Table 3; The design value is valid for "good bond conditions" according to EN 1992-1-1. All other condition: multiply value by 0,7. Mortar volume based on equation: $V = 1,2 \cdot (d_0^2 - d_s^2) \cdot \pi \cdot l_b / 4$

Powers Injection system AC100-PRO for rebar connection

Values for pre-calculation of overlap joints.
Example for:
C20/25; good bond condition; Rebar yield strength 500 N/mm²

Annex 12