

Approval body for construction products  
and types of construction

Bautechnisches Prüfamt

An institution established by the Federal and  
Laender Governments



## European Technical Assessment

ETA-11/0181  
of 3 July 2015

English translation prepared by DIBt - Original version in German language

### General Part

Technical Assessment Body issuing the  
European Technical Assessment:

Deutsches Institut für Bautechnik

Trade name of the construction product

G&B Gamma CE1

Product family  
to which the construction product belongs

Torque controlled expansion anchor for use in  
concrete

Manufacturer

G&B FISSAGGI  
Corso Savona, 22  
10029 Villatellone (TO)  
ITALIEN

Manufacturing plant

Italy - PLANT 5

This European Technical Assessment  
contains

15 pages including 3 annexes which form an integral part  
of this assessment

This European Technical Assessment is  
issued in accordance with Regulation (EU)  
No 305/2011, on the basis of

Guideline for European technical approval of "Metal  
anchors for use in concrete", ETAG 001 Part 2: "Torque  
controlled expansion anchors", April 2013,  
used as European Assessment Document (EAD)  
according to Article 66 Paragraph 3 of Regulation (EU)  
No 305/2011.

The European Technical Assessment is issued by the Technical Assessment Body in its official language. Translations of this European Technical Assessment in other languages shall fully correspond to the original issued document and shall be identified as such.

Communication of this European Technical Assessment, including transmission by electronic means, shall be in full. However, partial reproduction may only be made with the written consent of the issuing Technical Assessment Body. Any partial reproduction shall be identified as such.

This European Technical Assessment may be withdrawn by the issuing Technical Assessment Body, in particular pursuant to information by the Commission in accordance with Article 25(3) of Regulation (EU) No 305/2011.

## Specific Part

### 1 Technical description of the product

The G&B Gamma CE1 is an anchor made of galvanised steel of sizes M6, M8, M10, M12 and M16 which is placed into a drilled hole and anchored by torque-controlled expansion.  
The product description is given in Annex A.

### 2 Specification of the intended use in accordance with the applicable European Assessment Document

The performances given in Section 3 are only valid if the anchor is used in compliance with the specifications and conditions given in Annex B.  
The verifications and assessment methods on which this European Technical Assessment is based lead to the assumption of a working life of the anchor of at least 50 years. The indications given on the working life cannot be interpreted as a guarantee given by the producer, but are to be regarded only as a means for choosing the right products in relation to the expected economically reasonable working life of the works.

### 3 Performance of the product and references to the methods used for its assessment

#### 3.1 Mechanical resistance and stability (BWR 1)

Essential characteristic	Performance
Characteristic resistance for static and quasi static action and seismic performance category C1	See Annex C 1
Displacements	See Annex C 4

#### 3.2 Safety in case of fire (BWR 2)

Essential characteristic	Performance
Reaction to fire	Anchorage satisfy requirements for Class A1
Resistance to fire	See Annex C 2 / C 3

#### 3.3 Hygiene, health and the environment (BWR 3)

Not applicable.

#### 3.4 Safety in use (BWR 4)

The essential characteristics regarding Safety in use are included under the Basic Works Requirement Mechanical resistance and stability.

#### 3.5 Protection against noise (BWR 5)

Not applicable.

#### 3.6 Energy economy and heat retention (BWR 6)

Not applicable.

#### 3.7 Sustainable use of natural resources (BWR 7)

The sustainable use of natural resources was not investigated.

English translation prepared by DIBt

**3.8 General aspects**

The verification of durability is part of testing the essential characteristics. Durability is only ensured if the specifications of intended use according to Annex B are taken into account.

**4 Assessment and verification of constancy of performance (AVCP) system applied, with reference to its legal base**

According to Decision of the Commission of 24 June 1996 (96/582/EC) (OJ L 254 of 08.10.96 p. 62-65), the system of assessment and verification of constancy of performance (see Annex V and Article 65 Paragraph 2 to Regulation (EU) No 305/2011) given in the following table applies.

Product	Intended use	Level or class	System
Metal anchors for use in concrete (heavy-duty type)	For fixing and/or supporting concrete structural elements or heavy units such as cladding and suspended ceilings	—	1

**5 Technical details necessary for the implementation of the AVCP system, as provided for in the applicable European Assessment Document**

Technical details necessary for the implementation of the AVCP system are laid down in the control plan deposited at Deutsches Institut für Bautechnik.

Issued in Berlin on 3 July 2015 by Deutsches Institut für Bautechnik

Uwe Bender  
Head of Department

*beglaubigt:*  
Baderschneider

### Installed conditions

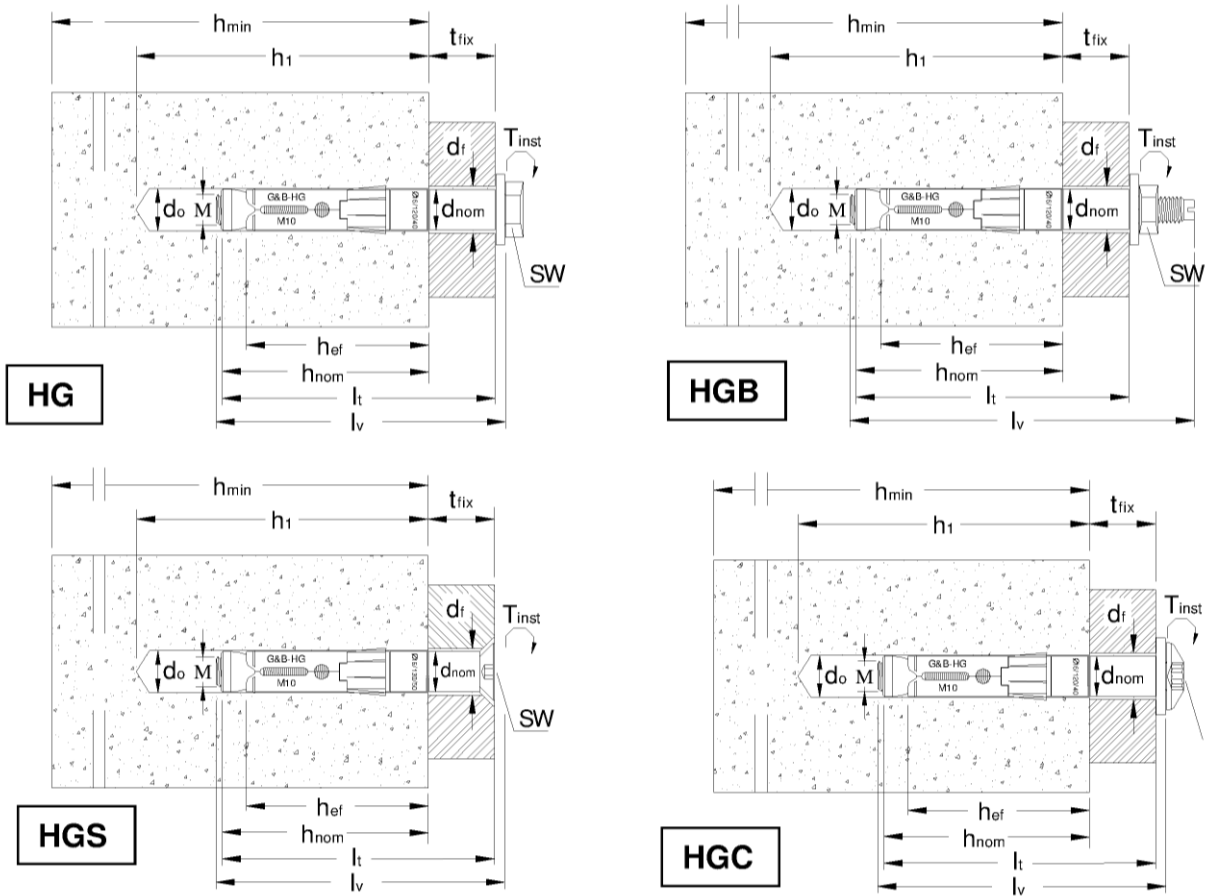

### Designation

$d_{nom}$	Outside diameter of the anchor
$T_{inst}$	Required torque moment
$t_{fix}$	Thickness of the fixtures
$d_0$	Diameter of the drill hole
$d_f$	Diameter of the clearance hole in the fixture
$h_{min}$	Minimum thickness of the concrete member
$h_{nom}$	Overall anchor embedment depth
$h_{ef}$	Anchorage depth
$l_t$	Anchor length
$l_v$	Bolt length
$T$	Hexalobular socket number
$SW$	Wrench size/Socket size
$H$	Hexagonal socket

**G&B Gamma CE1**

**Product description**  
Installed condition

**Annex A1**

**Anchor type HG with hexagonal head screw**

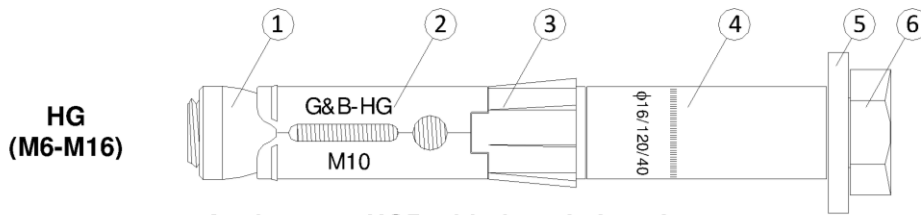

**HG**  
(M6-M16)

**Anchor type HGB with threaded stud**

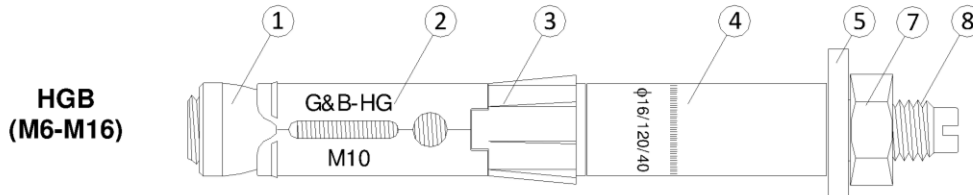

**HGB**  
(M6-M16)

**Anchor type HGS with flat countersunk head screw**

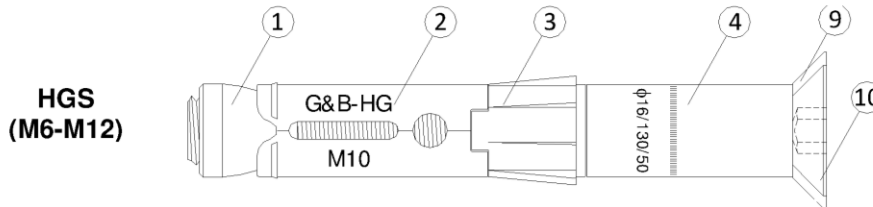

**HGS**  
(M6-M12)

**Anchor type HGC with mushroom head screw**

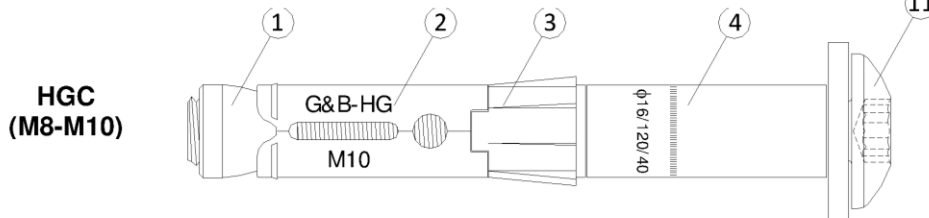

**HGC**  
(M8-M10)

**Marking**

**Expansion sleeve :**  
- Identifying mark of producer

- Trade name

- Anchor diameter

- Screw diameter

e.g : G&B-HG

φ16

M10

**Distance sleeve :**

- Anchor diameter

- Anchor length

- Maximum thickness of the fixture

e.g.: φ16/120/40

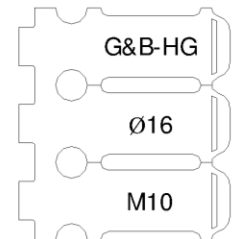

**Table A1:Materials**

ITEM	Description	Finishing
1	Zinc plated conical steel nut	Materials galvanised ≥ 5 [µm] according to ISO 4042:1999
2	Zinc plated expansion steel sleeve (marking: G&B-HG / bolt size, e.g. M10)	
3	Nylon 6.6 cylinder with helix, red brick color	
4	Zinc plated steel extension (marking: d <sub>nom</sub> /l <sub>t</sub> /t <sub>fix</sub> , e.g. Ø16/120/40)	
5	Zinc plated steel washer	
6	Zinc plated steel hexagonal head bolt, class 8.8 according to ISO 898-1:2012	
7	Zinc plated steel hexagonal nut, class 8 according to ISO 898-2:2012	
8	Zinc plated steel threaded stud, class 8.8 according to ISO 898-1:2012	
9	Zinc plated steel countersunk washer, according to EN 10083-6:2006	
10	Zinc plated steel flat countersunk head screw, class 8.8 according to ISO 898-1:2012	
11	Zinc plated steel mushroom head screw, class 8.8 according to ISO 898-1:2012	

**G&B Gamma CE1**

**Product description**  
Anchor types and components  
Materials

**Annex A2**

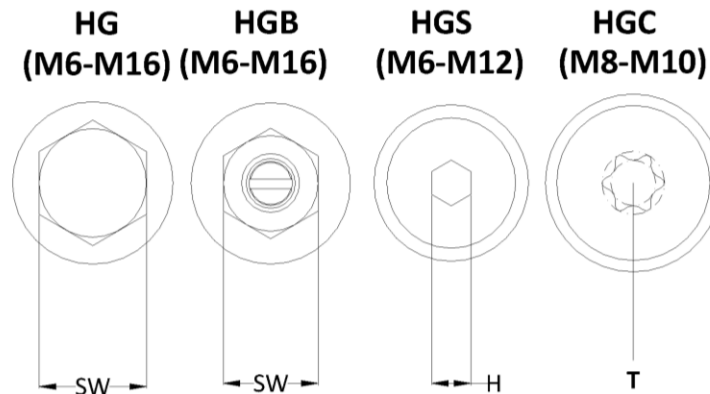

Table A2: HG dimensions

Item	Outside diameter of anchor [mm]	Outside diameter of metric thread [mm]	Length range [mm]	Maximum thickness of fixture range [mm]
HG-M6	10	6	70 - 120	5 - 15
HG-M8	12	8	80 - 140	10 - 70
HG-M10	16	10	100 - 160	20 - 80
HG-M12	18	12	120 - 200	20 - 100
HG-M16	24	16	140 - 220	20 - 100

Table A3: HGB dimensions

Item	Outside diameter of anchor [mm]	Outside diameter of metric thread [mm]	Length range [mm]	Maximum thickness of fixture range [mm]
HGB -M6	10	6	70 - 120	5 - 15
HGB -M8	12	8	80 - 140	10 - 70
HGB-M10	16	10	100 - 160	20 - 80
HGB-M12	18	12	120 - 200	20 - 100
HGB-M16	24	16	140 - 220	20 - 100

Table A4: HGS dimensions

Item	Outside diameter of anchor [mm]	Outside diameter of metric thread [mm]	Length range [mm]	Maximum thickness of fixture range [mm]
HGS-M6	10	6	85 - 125	20 - 60
HGS-M8	12	8	85 - 125	15 - 55
HGS-M10	16	10	110 - 130	30 - 50
HGS-M12	18	12	120 - 140	20 - 40

Table A5: HGC dimensions

Item	Outside diameter of anchor [mm]	Outside diameter of metric thread [mm]	Length range [mm]	Maximum thickness of fixture range [mm]
HGC-M8	12	8	80 - 120	10 - 50
HGC-M10	16	10	100 - 120	20 - 40

G&B Gamma CE1

Product description  
Anchor's dimensions

Annex A3

## Specifications of intended use

### Anchorage subject to:

- Static and quasi-static loads: all sizes
- Seismic action for Performance Category C1: all sizes
- Fire exposure: all sizes

### Base materials:

- Reinforced or unreinforced normal weight concrete according to EN 206-1:2000.
- Strength classes C20/25 to C50/60 according to EN 206-1:2000.
- Non-cracked or cracked concrete

### Use conditions (Environmental conditions):

- Anchorages subject to dry internal conditions

### Design:

- Anchorages are designed under the responsibility of an engineer experienced in anchorages and concrete work.
- Verifiable calculation notes and drawings are prepared taking account of the loads to be anchored. The position of the anchor is indicated on the design drawings (e.g. position of the anchor relative to reinforcement or to supports, etc.).
- Anchorages under static or quasi-static actions and under fire exposure are designed in accordance with:
  - ETAG 001, Annex C, design method A, Edition August 2010;
  - CEN TS CEN/TS 1992-4-1:2009;
- Anchorages under seismic actions (cracked concrete) are designed in accordance with:
  - EOTA Technical Report TR 045, Edition February 2013
  - Anchorages shall be positioned outside of critical regions (e.g. plastic hinges) of the concrete structure
  - Fastening in stand-off installation or with a grout layer are not allowed
- Anchorages under fire exposure are designed in accordance with:
  - ETAG 001, Annex C, design method A, Edition August 2010 and EOTA Technical Report TR 020, Edition May 2004
  - CEN/TS 1992-4: 2009, Annex D
  - It must be ensured that local spalling of the concrete cover does not occur

### Installation:

- Hole drilling by rotary plus hammer mode
- Anchor installation carried out by appropriately qualified personnel and under the supervision of the person responsible for technical matters of the site.
- In case of aborted hole: new drilling at a minimum distance away of twice the depth of the aborted hole or smaller distance if the aborted hole is filled with high strength mortar and if under shear or oblique tension load it is not the direction of the load application.

G&B Gamma CE1

Intended use  
Specifications

Annex B1



**Table B1: Installation parameters**

Parameter		Gamma	Gamma	Gamma	Gamma	Gamma
		CE1 M6	CE1 M8	CE1 M10	CE1 M12	CE1 M16
Nominal drill hole diameter	$d_o = [mm]$	10	12	16	18	24
Cutting diameter of drill bit	$d_{cut} \leq [mm]$	10,45	12,50	16,50	18,50	24,55
Effective anchorage depth	$h_{ef} = [mm]$	55	60	70	90	105
Depth of drill hole	$h_1 = [mm]$	80	90	100	120	140
Diameter of clearance in the fixture	$d_f = [mm]$	12	14	18	20	26
Overall anchor embedment depth in the	$h_{nom} = [mm]$	65	70	80	100	120
Required torque moment	$T_{inst} = [Nm]$	15	30	50	100	160
Outside diameter of anchor	$d_{nom} = [mm]$	10	12	16	18	24
Minimum thickness of concrete member	$h_{min} = [mm]$	110	120	140	180	210
Minimum edge distance	$c_{min} = [mm]$	70	100	90	175	180
Corresponding spacing	$s \geq [mm]$	110	160	175	255	290
Minimum spacing	$s_{min} = [mm]$	55	110	80	135	130
Corresponding edge distance	$c \geq [mm]$	110	145	120	220	240

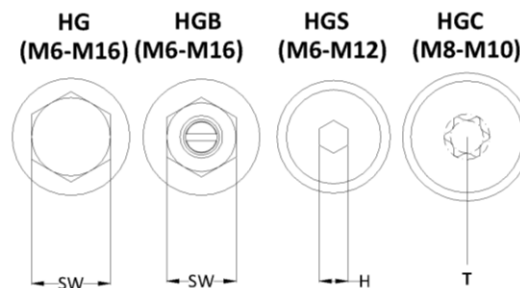

**Table B2: Wrenches, sockets and maximum thickness of fixture**

Wrenches and sockets		M6	M8	M10	M12	M16
Gamma CE 1 HG – Wrench size	SW = [mm]	10	13	17	19	24
Gamma CE 1 HG – Thickness of fixture	$t_{fix,max} = [mm]$	55	70	80	100	100
	$t_{fix,min} = [mm]$	5	10	20	20	20
Gamma CE 1 HGB – Wrench size	SW = [mm]	10	13	17	19	24
Gamma CE 1 HGB – Thickness of fixture	$t_{fix,max} = [mm]$	55	70	80	100	100
	$t_{fix,min} = [mm]$	5	10	20	20	20
Gamma CE 1 HGS – Hexagonal socket size	H = [mm]	4	5	6	8	-
Gamma CE 1 HGS – Thickness of fixture	$t_{fix,max} = [mm]$	60	55	50	100	-
	$t_{fix,min} = [mm]$	20	15	30	20	-
Gamma CE 1 HGC – Hexalobular socket	T = [-]	-	40	40	-	-
Gamma CE 1 HGC – Thickness of fixture	$t_{fix,max} = [mm]$	-	50	40	-	-
	$t_{fix,min} = [mm]$	-	10	20	-	-

**G&B Gamma CE1**

Intended use  
Installation parameters  
Wrenches, sockets and minimum thickness of fixture

**Annex B2**

**Drill bit**

Drill bits <b>GEBFOR TURBO4</b> 	Anchor size	Drill bit item code
	M6 / Ø10	PST1016
	M8 / Ø12	PST1216
	M10 / Ø16	PST1621
	M12 / Ø18	PST1825
	M16 / Ø24	PST2425

**Blowing pump**

Item code: CP10

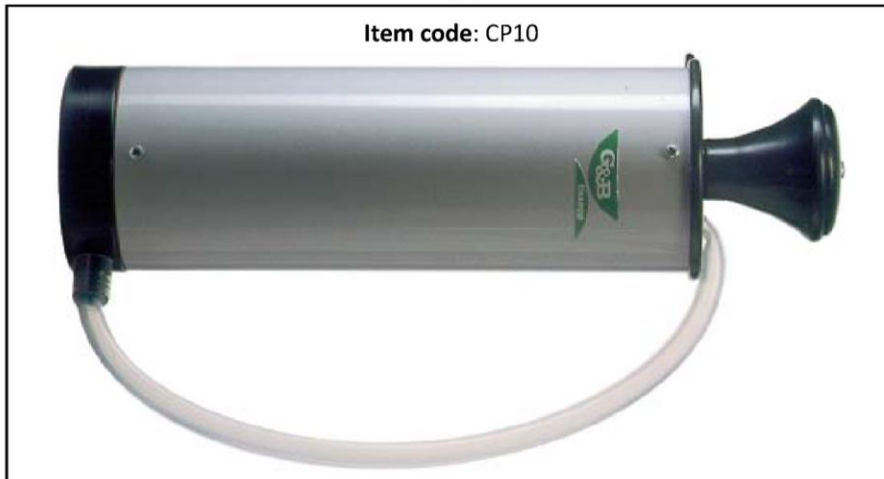

**G&B Gamma CE1**

**Intended use**  
Cleaning and setting tools

**Annex B3**

**Installation sequence GAMMA CE1 HG**

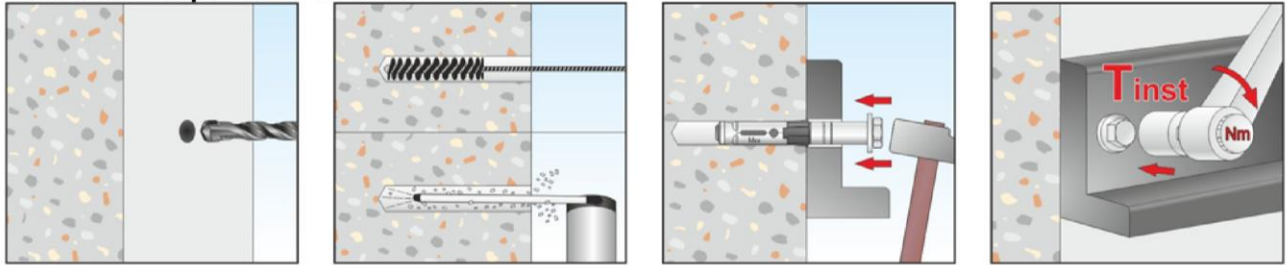

**Installation sequence GAMMA CE1 HGB**

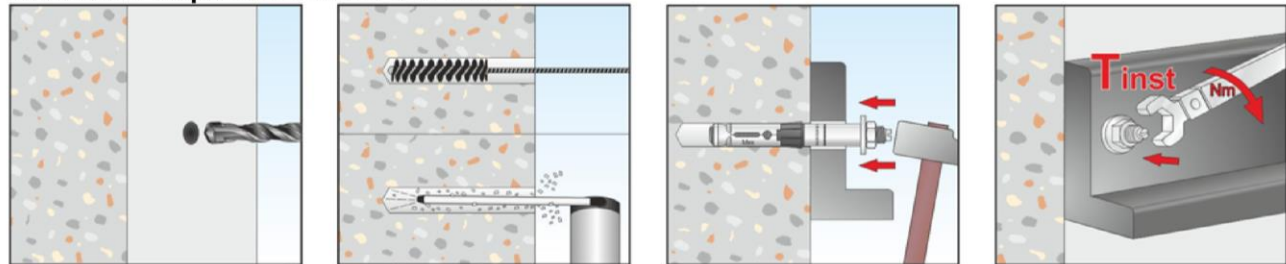

**Installation sequence GAMMA CE1 HGS**

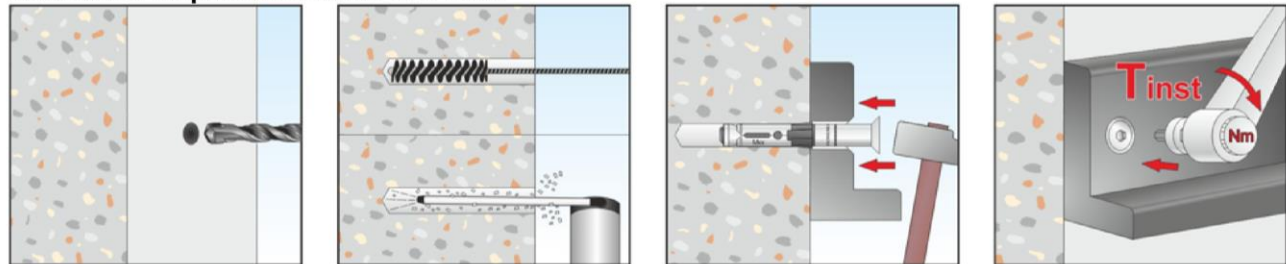

**Installation sequence GAMMA CE1 HGC**

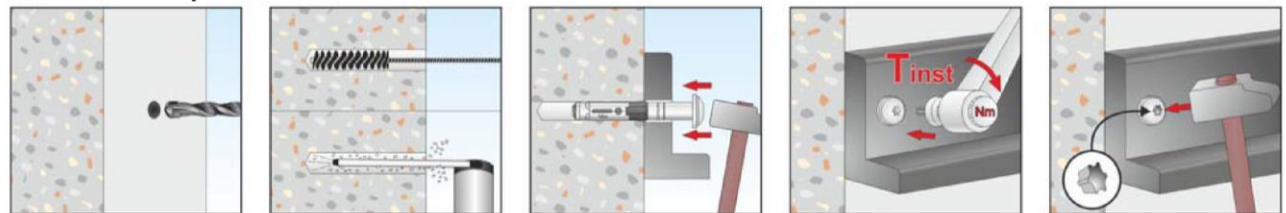

Step 1	Drill a hole into the concrete in rotary plus hammer mode
Step 2	Remove the dust into the hole using a brush and a blowing pump
Step 3	Place the fixture and hammer the anchor in the drill hole
Step 4	Apply the required torque moment

**G&B Gamma CE1**

**Intended use**  
Installation instructions

**Annex B4**

**Table C1: Performances for design method A (tension)**

Type of anchor / Size			Gamma CE1 M6	Gamma CE1 M8	Gamma CE1 M10	Gamma CE1 M12	Gamma CE1 M16
<b>Steel Failure</b>							
Characteristic Resistance	$N_{RK,s} = N_{RK,s,seis,C1}$	[kN]	16	29	46	67	125
Partial safety factor	$\gamma_{Ms}^{1)}$	[-]	1,5				
<b>Pull-out failure</b>							
Effective embedment depth	$h_{ef}$	[mm]	55	60	70	90	105
Characteristic Resistance in uncracked concrete C20/25	$N_{RK,p}$	[kN]	16	16	20	35	45
Characteristic Resistance in cracked concrete C20/25			5	6	16	25	35
Characteristic Resistance for seismic performance category C1	$N_{RK,p,seis,C1}$	[kN]	5	4,2	14,4	25	35
Increasing factors for $N_{RK,p}$ for cracked and uncracked concrete	$\Psi_c$	C30/37	1,22				
		C40/50	1,41				
		C50/60	1,55				
Installation safety factor	$\gamma_2 = \gamma_{inst}$	[-]	1,0				
<b>Concrete cone failure and splitting failure</b>							
Effective embedment depth	$h_{ef}$	[mm]	55	60	70	90	105
Spacing	$s_{cr,N}$	[mm]	165	180	210	270	315
Edge distance	$c_{cr,N}$	[mm]	85	90	105	135	160
Spacing (splitting)	$s_{cr,sp}$	[mm]	220	320	240	370	390
Edge distance (splitting)	$c_{cr,sp}$	[mm]	110	160	120	185	195
Factor for uncracked concrete, acc. to CEN/TS 1992-4	$k_{ucr}$	[-]	10,1				
Factor for cracked concrete, acc. to CEN/TS 1992-4	$k_{cr}$	[-]	7,2				
Installation safety factor	$\gamma_2 = \gamma_{inst}$	[-]	1,0				

<sup>1)</sup> In absence of other national regulations.

**Table C2: Performances for design method A (shear)**

Type of anchor / Size			Gamma CE1 M6	Gamma CE1 M8	Gamma CE1 M10	Gamma CE1 M12	Gamma CE1 M16
<b>Steel Failure without level arm</b>							
Characteristic Resistance	$V_{RK,s}$	[kN]	16	25	43	58	107
Characteristic Resistance for seismic performance category C1	$V_{RK,s,seis,C1}$	[kN]	11,4	17	28	43,5	96,3
Partial safety factor	$\gamma_{Ms}^{1)}$	[-]	1,45				
<b>Steel Failure with level arm</b>							
Characteristic bending moment	$M_{RK,s}^0$	[Nm]	12	30	60	105	266
Partial safety factor	$\gamma_{Ms}^{1)}$		1,45				
<b>Concrete pryout failure</b>							
Effective embedmen depth	$h_{ef}$	[mm]	55	60	70	90	105
Factor for pryout failure	$k = k_3$	[-]	1	2	2	2	2
Installation safety factor	$\gamma_2 = \gamma_{inst}$	[-]	1,0				
<b>Concrete edge failure</b>							
Effective achorage legh	$l_{ef}$	[mm]	55	60	70	90	105
Effective external diameter anchor	$d_{nom}$	[mm]	10	12	16	18	24
Installation safety factor	$\gamma_2 = \gamma_{inst}$	[-]	1,0				

<sup>1)</sup> In absence of other national regulations.

**G&B Gamma CE1**

**Performances**  
Characteristic resistance to tension loads under static and quasi-static actions and seismic performance category C1

**Annex C1**

**Table C3: Performances under fire exposure in concrete C20/25 to C50/60 (tension)**

Duration of fire resistance = 30min, anchor type Gamma CE 1			M6	M8	M10	M12	M16
<b>Steel Failure</b>							
Characteristic Resistance	$N_{Rk,s,fi,30}$	[kN]	0,2	0,4	0,9	1,7	3,1
<b>Pull-out failure</b>							
Characteristic Resistance in concrete C20/25 to C50/60	$N_{Rk,p,fi,30}$	[kN]	1,3	1,5	4,0	6,3	8,8
<b>Concrete cone failure</b>							
Characteristic Resistance in concrete C20/25 to C50/60	$N^0_{Rk,c,fi,30}$	[kN]	4,0	5,0	7,4	13,8	20,3
Duration of fire resistance = 60min, anchor type Gamma CE 1			M6	M8	M10	M12	M16
<b>Steel Failure</b>							
Characteristic Resistance	$N_{Rk,s,fi,60}$	[kN]	0,2	0,3	0,8	1,3	2,4
<b>Pull-out failure</b>							
Characteristic Resistance in concrete C20/25 to C50/60	$N_{Rk,p,fi,60}$	[kN]	1,3	1,5	4,0	6,3	8,8
<b>Concrete cone failure</b>							
Characteristic Resistance in concrete C20/25 to C50/60	$N^0_{Rk,c,fi,60}$	[kN]	4,0	5,0	7,4	13,8	20,3
Duration of fire resistance = 90min, anchor type Gamma CE 1			M6	M8	M10	M12	M16
<b>Steel Failure</b>							
Characteristic Resistance	$N_{Rk,s,fi,90}$	[kN]	0,1	0,3	0,6	1,1	2,0
<b>Pull-out failure</b>							
Characteristic Resistance in concrete C20/25 to C50/60	$N_{Rk,p,fi,90}$	[kN]	1,3	1,5	4,0	6,3	8,8
<b>Concrete cone failure</b>							
Characteristic Resistance in concrete C20/25 to C50/60	$N_{Rk,c,fi,90}$	[kN]	4,0	5,0	7,4	13,8	20,8
Duration of fire resistance = 120min, anchor type Gamma CE 1			M6	M8	M10	M12	M16
<b>Steel Failure</b>							
Characteristic Resistance	$N_{Rk,s,fi,120}$	[kN]	0,1	0,2	0,5	0,8	1,6
<b>Pull-out failure</b>							
Characteristic Resistance in concrete C20/25 to C50/60	$N_{Rk,p,fi,120}$	[kN]	1,0	1,2	3,2	5,0	7,0
<b>Concrete cone failure</b>							
Characteristic Resistance in concrete C20/25 to C50/60	$N^0_{Rk,c,fi,120}$	[kN]	3,2	4,0	5,9	11,1	16,3
Spacing	$s_{cr,N}$	[mm]	<b>4 x <math>h_{ef}</math></b>				
	$s_{min}$		55	110	80	135	130
Edge distance	$c_{cr,N}$		<b>2 x <math>h_{ef}</math></b>				
	$c_{min}$		$c_{min} = 2xh_{ef}$ ; If fire attack comes from more than one side, the edge distance of the anchor has to be $\geq 300\text{mm}$ or $\geq 2 x h_{ef}$				

**G&B Gamma CE1**

**Performances**  
Characteristic values for tension loads under fire exposure

**Annex C2**

**Table C4: Performances under fire exposure in concrete C20/25 to C50/60 (shear)**

Duration of fire resistance = 30min, anchor type Gamma CE 1		M6	M8	M10	M12	M16
<b>Shear load without lever arm</b>						
Characteristic resistance	$V_{Rk,s,fi,30}$ [kN]	0,3	0,5	1,2	2,1	3,9
<b>Shear load with lever arm</b>						
Characteristic bending resistance	$M_{Rk,s,fi,30}^0$ [Nm]	0,2	0,4	1,1	2,6	6,7
Duration of fire resistance = 60min, anchor type Gamma CE 1		M6	M8	M10	M12	M16
<b>Shear load without lever arm</b>						
Characteristic resistance	$V_{Rk,s,fi,60}$ [kN]	0,3	0,4	1,0	1,6	2,9
<b>Shear load with lever arm</b>						
Characteristic bending resistance	$M_{Rk,s,fi,60}^0$ [Nm]	0,1	0,3	1,0	2,0	5,0
Duration of fire resistance = 90min, anchor type Gamma CE 1		M6	M8	M10	M12	M16
<b>Shear load without lever arm</b>						
Characteristic resistance	$V_{Rk,s,fi,90}$ [kN]	0,2	0,3	0,8	1,4	2,5
<b>Shear load with lever arm</b>						
Characteristic bending resistance	$M_{Rk,s,fi,90}^0$ [Nm]	0,1	0,3	0,8	1,7	4,3
Duration of fire resistance = 120min, anchor type Gamma CE 1		M6	M8	M10	M12	M16
<b>Shear load without lever arm</b>						
Characteristic resistance	$V_{Rk,s,fi,120}$ [kN]	0,2	0,2	0,6	1,0	1,9
<b>Shear load with lever arm</b>						
Characteristic bending resistance	$M_{Rk,s,fi,120}^0$ [Nm]	0	0,2	0,6	1,3	3,3
<b>Concrete pryout failure</b>						
The characteristic resistance $V_{Rk,cp,fi,Ri}$ in concrete C20/25 to C50/60 is determined by: $V_{Rk,cp,fi(90)} = k \times N_{Rk,c,fi(90)} (\leq R90)$ and $V_{Rk,cp,fi(120)} = k \times N_{Rk,c,fi(120)}$ (up to R120)						
<b>Concrete edge failure</b>						
The characteristic resistance $V_{Rk,c,fi,Ri}$ in concrete C20/25 to C50/60 is determined by: $V_{Rk,c,fi(90)}^0 = 0,25 \times V_{Rk,c}^0$ (R30, R60, R90) and $V_{Rk,c,fi(120)}^0 = 0,20 \times V_{Rk,c}^0$ (R120) with $V_{Rk,c}^0$ as an initial value of the characteristic resistance of a single anchor in cracked concrete C20/25						

**G&B Gamma CE1**

**Performances**  
Characteristic values for shear loads under fire exposure

**Annex C3**

**Table C5 : Displacements**

<b>Tension loads in cracked and uncracked concrete</b>			<b>M6</b>	<b>M8</b>	<b>M10</b>	<b>M12</b>	<b>M16</b>
Service tension load in uncracked concrete C20/25	N	[kN]	7,6	7,6	9,5	16,7	21,4
Displacements	$\delta_{N0}$	[mm]	1,3	1,5	1,0	1,3	1,8
	$\delta_{N\infty}$	[mm]	1,3	1,5	1,0	1,3	1,8
Service tension load in cracked concrete C20/25	N	[kN]	2,4	2,9	7,6	11,9	16,7
Displacements	$\delta_{N0}$	[mm]	1,0	0,7	1,0	1,2	1,5
	$\delta_{N\infty}$	[mm]	1,6	1,3	1,6	1,7	1,5
<b>Shear loads in cracked and uncracked concrete</b>			<b>M6</b>	<b>M8</b>	<b>M10</b>	<b>M12</b>	<b>M16</b>
Service shear load in cracked and uncracked concrete C20/25	V	[kN]	7,7	12,3	21,0	23,3	52,5
Displacements	$\delta_{N0}$	[mm]	2,4	2,6	2,5	3,0	4,0
	$\delta_{N\infty}$	[mm]	3,6	3,9	3,8	4,5	6,0

**G&B Gamma CE1**

**Performances**  
**Displacements**

**Annex C4**