

Approval body for construction products
and types of construction

Bautechnisches Prüfamt

An institution established by the Federal and
Laender Governments



European Technical Assessment

ETA-11/0181
of 21 August 2017

English translation prepared by DIBt - Original version in German language

General Part

Technical Assessment Body issuing the
European Technical Assessment:

Deutsches Institut für Bautechnik

Trade name of the construction product

G&B Gamma CE1

Product family
to which the construction product belongs

Torque controlled expansion anchor
for use in concrete

Manufacturer

G&B FISSAGGI
Corso Savona, 22
10029 Villatellone (TO)
ITALIEN

Manufacturing plant

Italy - PLANT 5

This European Technical Assessment
contains

16 pages including 3 annexes which form an integral part
of this assessment

This European Technical Assessment is
issued in accordance with Regulation (EU)
No 305/2011, on the basis of

European Assessment Document (EAD)
330232-00-0601

This version replaces

ETA-11/0181 issued on 3 July 2015

European Technical Assessment

ETA-11/0181

English translation prepared by DIBt

Page 2 of 16 | 21 August 2017

The European Technical Assessment is issued by the Technical Assessment Body in its official language. Translations of this European Technical Assessment in other languages shall fully correspond to the original issued document and shall be identified as such.

Communication of this European Technical Assessment, including transmission by electronic means, shall be in full. However, partial reproduction may only be made with the written consent of the issuing Technical Assessment Body. Any partial reproduction shall be identified as such.

This European Technical Assessment may be withdrawn by the issuing Technical Assessment Body, in particular pursuant to information by the Commission in accordance with Article 25(3) of Regulation (EU) No 305/2011.

Specific Part

1 Technical description of the product

The G&B Gamma CE1 is an anchor made of galvanised steel of sizes M6, M8, M10, M12 and M16 which is placed into a drilled hole and anchored by torque-controlled expansion.

The product description is given in Annex A.

2 Specification of the intended use in accordance with the applicable European Assessment Document

The performances given in Section 3 are only valid if the anchor is used in compliance with the specifications and conditions given in Annex B.

The verifications and assessment methods on which this European Technical Assessment is based lead to the assumption of a working life of the anchor of at least 50 years. The indications given on the working life cannot be interpreted as a guarantee given by the producer, but are to be regarded only as a means for choosing the right products in relation to the expected economically reasonable working life of the works.

3 Performance of the product and references to the methods used for its assessment

3.1 Mechanical resistance and stability (BWR 1)

Essential characteristic	Performance
Characteristic resistance for static and quasi static action and seismic performance category C1 and C2	See Annex C 1 / C 2
Displacements	See Annex C 5

3.2 Safety in case of fire (BWR 2)

Essential characteristic	Performance
Reaction to fire	Anchorage satisfy requirements for Class A1
Resistance to fire	See Annex C 3 / C 4

4 Assessment and verification of constancy of performance (AVCP) system applied, with reference to its legal base

In accordance with European Assessment Documents EAD No. 330232-00-0601 the applicable European legal act is: [96/582/EC].

The system to be applied is: 1

5 Technical details necessary for the implementation of the AVCP system, as provided for in the applicable European Assessment Document

Technical details necessary for the implementation of the AVCP system are laid down in the control plan deposited at Deutsches Institut für Bautechnik.

Issued in Berlin on 21 August 2017 by Deutsches Institut für Bautechnik

Lars Eckfeldt
p.p. Head of Department

beglaubigt:
Baderschneider

Installed conditions

Installation for static, quasi-static and seismic performance category C1 and C2

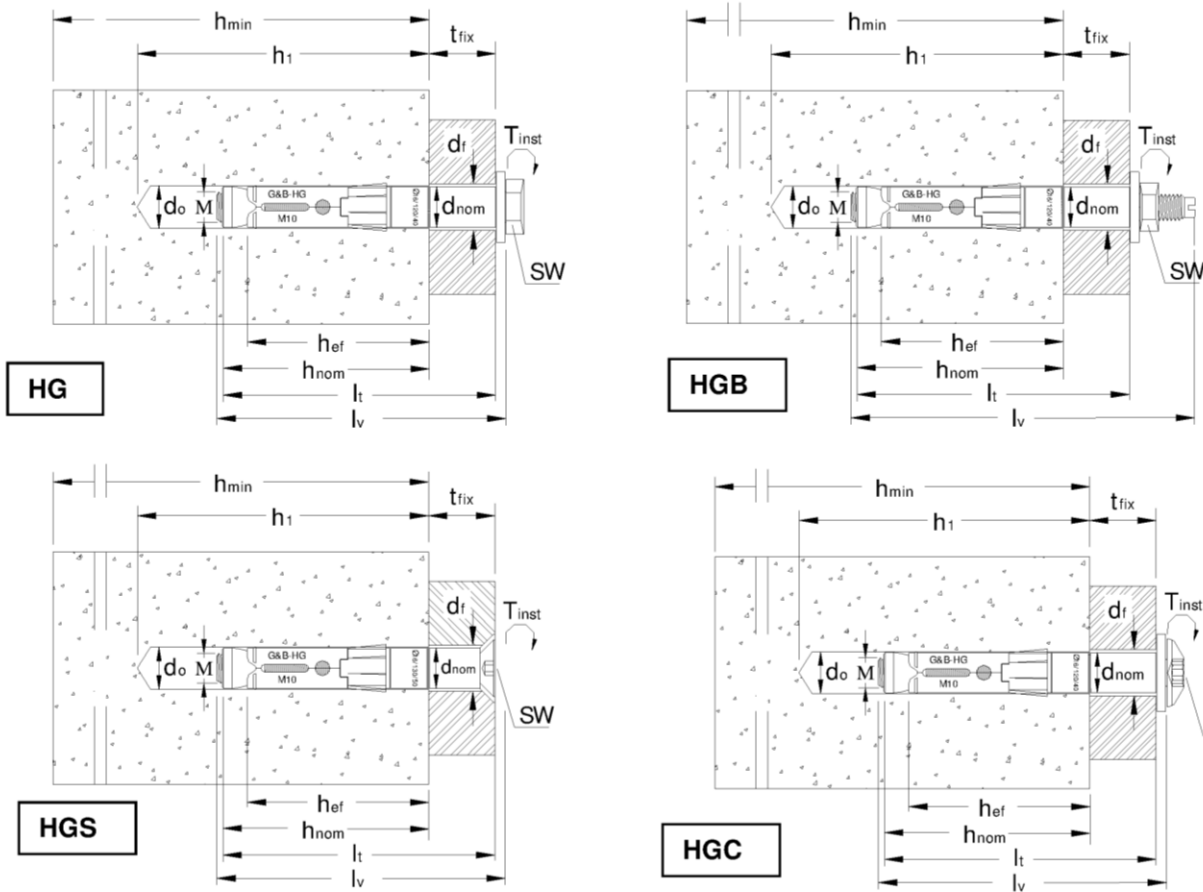

Designation

d_{nom}	Outside diameter of the anchor
T_{inst}	Required torque moment
t_{fix}	Thickness of the fixtures
d_0	Diameter of the drill hole
d_f	Diameter of the clearance hole in the fixture
h_{min}	Minimum thickness of the concrete member
h_{nom}	Overall anchor embedment depth
h_{ef}	Anchorage depth
l_t	Anchor length
l_v	Bolt length
T	Hexalobular socket number
SW	Wrench size/Socket size
H	Hexagonal socket

G&B Gamma CE1

Product description
Installed condition

Annex A 1

 <p style="text-align: center;">Anchor type Gamma CE 1 HG with hexagonal head screw</p>	HG
 <p style="text-align: center;">Anchor type Gamma CE 1 HGB with threaded stud</p>	HGB
 <p style="text-align: center;">Anchor type Gamma CE 1 HGS with flat countersunk head screw</p>	HGS
 <p style="text-align: center;">Anchor type Gamma CE 1 HGC with mushroom head screw</p>	HGC

Table A1: Materials

ITEM	Description	Finishing
1	Zinc plated conical steel nut	Materials galvanised ≥ 5 [μm] according to ISO 4042:1999
2	Zinc plated expansion steel sleeve (marking: G&B-HG / bolt size, e.g. M10)	
3	Nylon 6.6 cylinder with helix, red brick color	
4	Zinc plated steel extension (marking: $d_{\text{nom}}/l_t/t_{\text{fix}}$, e.g. $\emptyset 16/120/40$)	
5	Zinc plated steel washer	
6	Zinc plated steel hexagonal head bolt, class 8.8 according to ISO 898-1:2012	
7	Zinc plated steel hexagonal nut, class 8 according to ISO 898-2:2012	
8	Zinc plated steel threaded stud, class 8.8 according to ISO 898-1:2012	
9	Zinc plated steel countersunk washer, according to EN 10083:2006	
10	Zinc plated steel flat countersunk head screw, class 8.8 acc.to ISO 898-1:2012	
11	Zinc plated steel mushroom head screw, class 8.8 according to ISO 898-1:2012	

G&B Gamma CE1

Product description
Anchor types and components

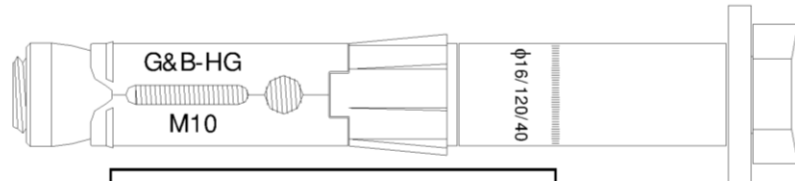
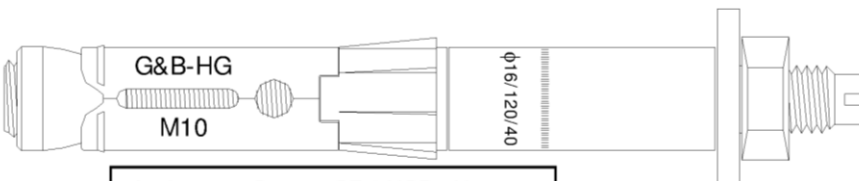
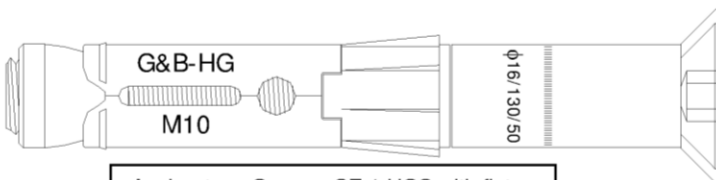
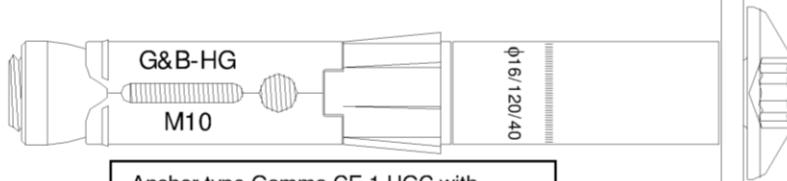
Annex A 2

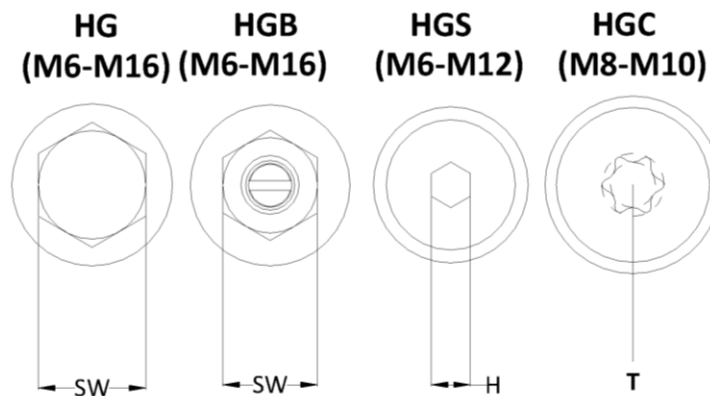

Table A2: HG dimensions

Item	Outside diameter of anchor [mm]	Outside diameter of metric thread [mm]	Length range [mm]	Maximum thickness of fixture range [mm]
HG-M6	10	6	70 - 200	5 - 135
HG-M8	12	8	80 - 200	10 - 130
HG-M10	16	10	90 - 200	10 - 120
HG-M12	18	12	110 - 250	10 - 150
HG-M16	24	16	130 - 300	10 - 180

Table A3: HGB dimensions

Item	Outside diameter of anchor [mm]	Outside diameter of metric thread [mm]	Length range [mm]	Maximum thickness of fixture range [mm]
HGB -M6	10	6	70 - 200	5 - 135
HGB -M8	12	8	80 - 200	10 - 130
HGB-M10	16	10	90 - 200	10 - 120
HGB-M12	18	12	110 - 250	10 - 150
HGB-M16	24	16	130 - 300	10 - 180

Table A4: HGS dimensions

Item	Outside diameter of anchor [mm]	Outside diameter of metric thread [mm]	Length range [mm]	Maximum thickness of fixture range [mm]
HGS-M6	10	6	70 - 205	5 - 140
HGS-M8	12	8	85 - 205	15 - 135
HGS-M10	16	10	100 - 200	20 - 120
HGS-M12	18	12	120 - 200	20 - 100

Table A5: HGC dimensions

Item	Outside diameter of anchor [mm]	Outside diameter of metric thread [mm]	Length range [mm]	Maximum thickness of fixture range [mm]
HGC-M8	12	8	80 - 200	10 - 130
HGC-M10	16	10	100 - 200	20 - 120

G&B Gamma CE1

Product description
Anchor's dimensions

Annex A 3

Specifications of intended use

Anchorage subject to:

- Static and quasi-static loads: all sizes
- Seismic action for Performance Category C1: all sizes
- Seismic action for Performance Category C2: all sizes
- Resistance to fire exposure: all sizes

Base materials:

- Reinforced or unreinforced normal weight concrete according to EN 206-1:2000.
- Strength classes C20/25 to C50/60 according to EN 206-1:2000.
- Non-cracked or cracked concrete

Use conditions (Environmental conditions):

- Anchorages subject to dry internal conditions

Design:

- Anchorages are designed under the responsibility of an engineer experienced in anchorages and concrete work.
- Verifiable calculation notes and drawings are prepared taking account of the loads to be anchored. The position of the anchor is indicated on the design drawings (e.g. position of the anchor relative to reinforcement or to supports, etc.).
- Design of fastenings in accordance to FprEN 1992-4:2016 and EOTA Technical Report TR 055

Installation:

- Hole drilling by rotary plus hammer mode
- Anchor installation carried out by appropriately qualified personnel and under the supervision of the person responsible for technical matters of the site.
- In case of aborted hole: new drilling at a minimum distance away of twice the depth of the aborted hole or smaller distance if the aborted hole is filled with high strength mortar and if under shear or oblique tension load it is not the direction of the load application.

G&B Gamma CE1

Intended use
Specifications

Annex B 1

Table B1: Installation parameters

Parameter		Gamma CE1 M6	Gamma CE1 M8	Gamma CE1 M10	Gamma CE1 M12	Gamma CE1 M16
Nominal drill hole diameter	$d_o = [\text{mm}]$	10	12	16	18	24
Cutting diameter of drill bit	$d_{\text{cut}} \leq [\text{mm}]$	10,45	12,50	16,50	18,50	24,55
Effective anchorage depth	$h_{\text{ef}} = [\text{mm}]$	55	60	70	90	105
Depth of drill hole	$h_1 = [\text{mm}]$	80	90	100	120	140
Diameter of clearance in the fixture	$d_f = [\text{mm}]$	12	14	18	20	26
Overall anchor embedment depth in the	$h_{\text{nom}} = [\text{mm}]$	65	70	80	100	120
Required torque moment	$T_{\text{inst}} = [\text{Nm}]$	15	30	50	100	160
Outside diameter of anchor	$d_{\text{nom}} = [\text{mm}]$	10	12	16	18	24
Minimum thickness of concrete member	$h_{\text{min}} = [\text{mm}]$	110	120	140	180	210
Minimum edge distance	$c_{\text{min}} = [\text{mm}]$	70	100	90	175	180
	$s \geq [\text{mm}]$	110	160	175	255	290
Minimum spacing	$s_{\text{min}} = [\text{mm}]$	55	110	80	135	130
	$c \geq [\text{mm}]$	110	145	120	220	240

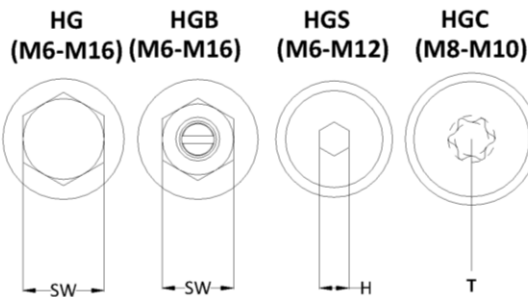

Table B2: Wrenches, sockets and maximum thickness of fixture

Item		M6	M8	M10	M12	M16
Gamma CE1 HG – Wrench size	$SW = [\text{mm}]$	10	13	17	19	24
Thickness of fixture	$t_{\text{fix,max}} = [\text{mm}]$	55	70	80	100	100
	$t_{\text{fix,min}} = [\text{mm}]$	5	10	20	20	20
Gamma CE1 HGB – Wrench size	$SW = [\text{mm}]$	10	13	17	19	24
Thickness of fixture	$t_{\text{fix,max}} = [\text{mm}]$	55	70	80	100	100
	$t_{\text{fix,min}} = [\text{mm}]$	5	10	20	20	20
Gamma CE1 HGS – Hexagonal socket size	$H = [\text{mm}]$	4	5	6	8	-
Thickness of fixture	$t_{\text{fix,max}} = [\text{mm}]$	60	55	50	100	-
	$t_{\text{fix,min}} = [\text{mm}]$	20	15	30	20	-
Gamma CE1 HGC – Hexalobular socket number	$T = [-]$	-	40	40	-	-
Thickness of fixture	$t_{\text{fix,max}} = [\text{mm}]$	-	50	40	-	-
	$t_{\text{fix,min}} = [\text{mm}]$	-	10	20	-	-

G&B Gamma CE1

Intended use
Installation parameters

Annex B 2

Drill bit

Drill bits GEBFOR TURBO4 	Anchor size	Drill bit item code
	M6 / Ø10	PST1016
	M8 / Ø12	PST1216
	M10 / Ø16	PST1621
	M12 / Ø18	PST1825
	M16 / Ø24	PST2425

Blowing pump

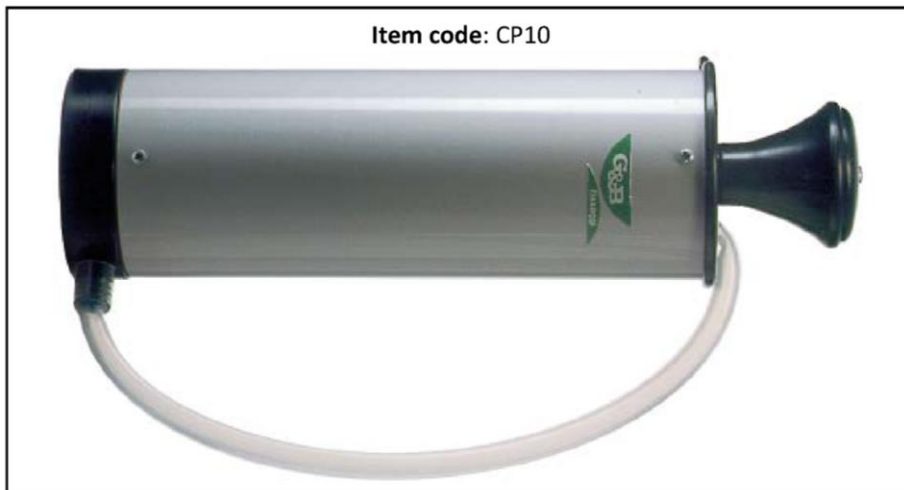

G&B Gamma CE1

Intended use
Cleaning and setting tools

Annex B 3

Installation sequence GAMMA CE1 HG

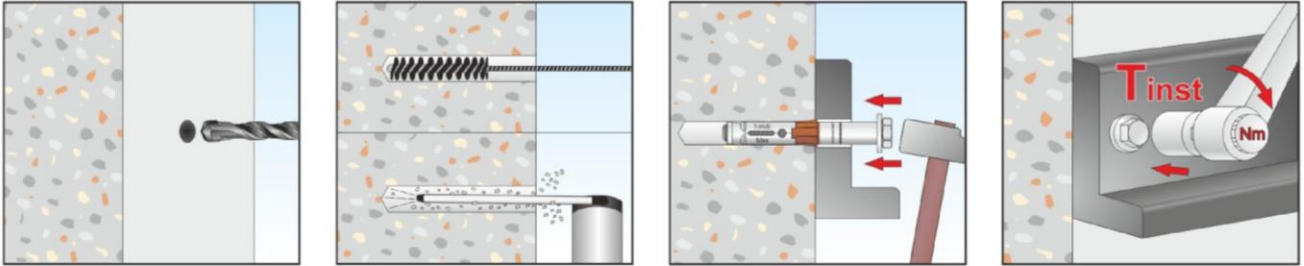

Installation sequence GAMMA CE1 HGB

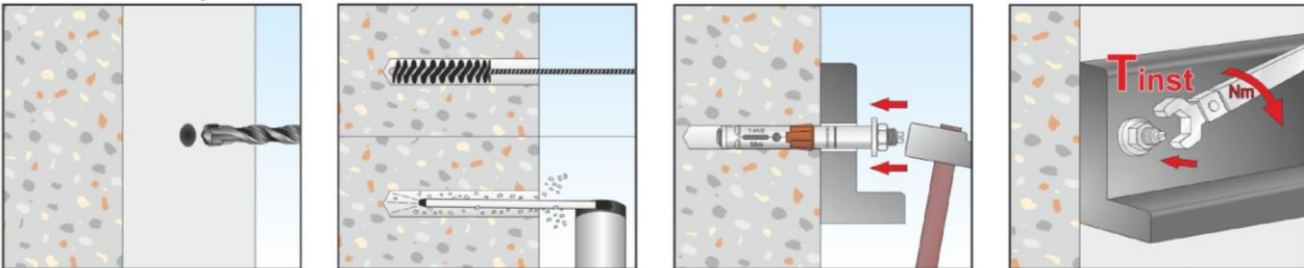

Installation sequence GAMMA CE1 HGS

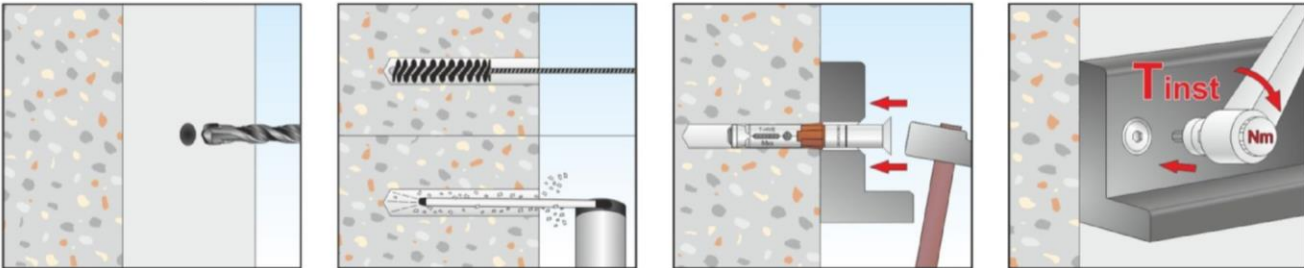

Installation sequence GAMMA CE1 HGC

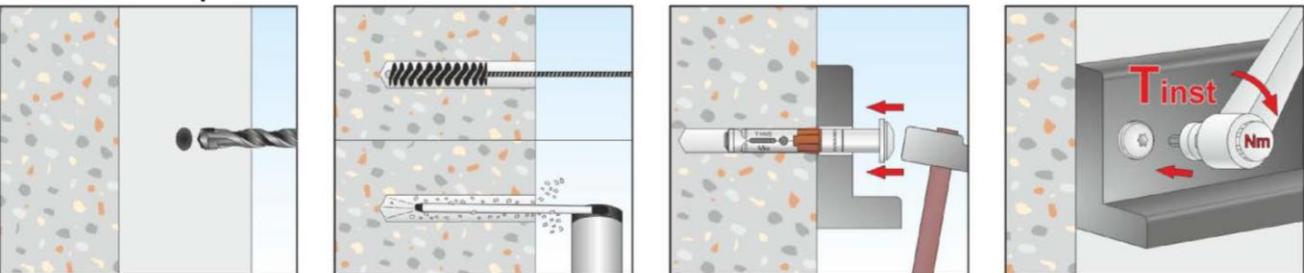

Step 1	Drill a hole into the concrete in rotary plus hammer mode
Step 2	Remove the dust into the hole using a 4 times a brush and 4 times a blowing pump
Step 3	Place the fixture and hammer the anchor in the drill hole
Step 4	Apply the required torque moment

G&B Gamma CE1

Intended use
Installation instructions

Annex B 4

Table C1: Performances for design, tension

Type of anchor / Size			Gamma CE1 M6	Gamma CE1 M8	Gamma CE1 M10	Gamma CE1 M12	Gamma CE1 M16
Steel Failure							
Characteristic Resistance	$N_{Rk,s}$ $N_{Rk,s,eq,C1}$ $N_{Rk,s,eq,C2}$	[kN]	16	29	46	67	125
Partial safety factor	$\gamma_{Ms}^{1)}$	[-]	1,5				
Pull-out failure							
Effective embedment depth	h_{ef}	[mm]	55	60	70	90	105
Characteristic Resistance in uncracked concrete C20/25	$N_{Rk,p}$	[kN]	16	16	20	35	45
Characteristic Resistance in cracked concrete C20/25			5	6	16	25	35
Characteristic Resistance for seismic performance category C1	$N_{Rk,p,eq}$	[kN]	5	4,2	14,4	25	35
Characteristic Resistance for seismic performance category C2	$N_{Rk,p,eq}$	[kN]	3,9	4,2	11,7	18,5	31
Increasing factors for $N_{Rk,p}$ for cracked and uncracked concrete	Ψ_c	C30/37	1,22				
		C40/50	1,41				
		C50/60	1,58				
Installation safety factor	γ_{inst}	[-]	1,0				
Concrete cone failure and splitting failure							
Effective embedment depth	h_{ef}	[mm]	55	60	70	90	105
Factor for k_1	$k_{ucr,N}$	[-]	11,0				
Factor for k_1	$k_{cr,N}$	[-]	7,7				
Spacing	$s_{cr,N}$	[mm]	165	180	210	270	315
Edge distance	$c_{cr,N}$	[mm]	85	90	105	135	160
Spacing (splitting)	$s_{cr,sp}$	[mm]	220	320	240	370	390
Edge distance (splitting)	$c_{cr,sp}$	[mm]	110	160	120	185	195
Installation safety factor	γ_{inst}	[-]	1,0				

¹⁾ In absence of other national regulations.

G&B Gamma CE1

Performances
Characteristic resistance to tension loads

Annex C 1

Table C2: Performances for design, shear

Type of anchor / Size			Gamma CE1 M6	Gamma CE1 M8	Gamma CE1 M10	Gamma CE1 M12	Gamma CE1 M16
Steel Failure without level arm							
Characteristic Resistance	$V_{Rk,s}$	[kN]	16	25	43	58	107
Characteristic Resistance for seismic performance category C1	$V_{Rk,s,eq}$	[kN]	11,4	17	28	43,5	96,3
Characteristic Resistance for seismic performance category C2	$V_{Rk,s,eq}$	[kN]	6,0	10,7	23,2	40,6	74,9
Partial safety factor	$\gamma_{Ms}^{1)}$	[-]	1,45				
Steel Failure with level arm							
Characteristic bending moment	$M_{Rk,s}^0$	[Nm]	12	30	60	105	266
Ductility factor	k_7	[-]	0,8				
Partial safety factor	$\gamma_{Ms}^{1)}$	[-]	1,45				
Concrete pryout failure							
Effective embedmen depth	h_{ef}	[mm]	55	60	70	90	105
Factor for pryout failure	k_8	[-]	1	2	2	2	2
Installation safety factor	γ_{inst}	[-]	1,0				
Concrete edge failure							
Effective achorage legth	l_{ef}	[mm]	55	60	70	90	105
Effective external diameter anchor	d_{nom}	[mm]	10	12	16	18	24
Installation safety factor	γ_{inst}	[-]	1,0				

¹⁾ In absence of other national regulations.

G&B Gamma CE1

Performances
Characteristic resistance to shear loads

Annex C 2

Table C3: Performances under fire exposure in concrete C20/25 to C50/60 (tension)

Duration of fire resistance = 30min, anchor type Gamma CE 1			M6	M8	M10	M12	M16
Steel Failure							
Characteristic Resistance	$N_{Rk,s,fi,30}$	[kN]	0,2	0,4	0,9	1,7	3,1
Pull-out failure							
Characteristic Resistance in concrete C20/25 to C50/60	$N_{Rk,p,fi,30}$	[kN]	1,3	1,5	4,0	6,3	8,8
Concrete cone failure							
Characteristic Resistance in concrete C20/25 to C50/60	$N_{Rk,c,fi,30}$	[kN]	4,0	5,0	7,4	13,8	20,3
Duration of fire resistance = 60min, anchor type Gamma CE 1			M6	M8	M10	M12	M16
Steel Failure							
Characteristic Resistance	$N_{Rk,s,fi,60}$	[kN]	0,2	0,3	0,8	1,3	2,4
Pull-out failure							
Characteristic Resistance in concrete C20/25 to C50/60	$N_{Rk,p,fi,60}$	[kN]	1,3	1,5	4,0	6,3	8,8
Concrete cone failure							
Characteristic Resistance in concrete C20/25 to C50/60	$N_{Rk,c,fi,60}$	[kN]	4,0	5,0	7,4	13,8	20,3
Duration of fire resistance = 90min, anchor type Gamma CE 1			M6	M8	M10	M12	M16
Steel Failure							
Characteristic Resistance	$N_{Rk,s,fi,90}$	[kN]	0,1	0,3	0,6	1,1	2,0
Pull-out failure							
Characteristic Resistance in concrete C20/25 to C50/60	$N_{Rk,p,fi,90}$	[kN]	1,3	1,5	4,0	6,3	8,8
Concrete cone failure							
Characteristic Resistance in concrete C20/25 to C50/60	$N_{Rk,c,fi,90}$	[kN]	4,0	5,0	7,4	13,8	20,8
Duration of fire resistance = 120min, anchor type Gamma CE 1			M6	M8	M10	M12	M16
Steel Failure							
Characteristic Resistance	$N_{Rk,s,fi,120}$	[kN]	0,1	0,2	0,5	0,8	1,6
Pull-out failure							
Characteristic Resistance in concrete C20/25 to C50/60	$N_{Rk,p,fi,120}$	[kN]	1,0	1,2	3,2	5,0	7,0
Concrete cone failure							
Characteristic Resistance in concrete C20/25 to C50/60	$N_{Rk,c,fi,120}$	[kN]	3,2	4,0	5,9	11,1	16,3
Spacing	$S_{cr,N}$	[mm]	4 x h_{ef}				
	S_{min}		55	110	80	135	130
Edge distance	$C_{cr,N}$		2 x h_{ef}				
	C_{min}		$C_{min} = 2xh_{ef}$; If fire attack comes from more than one side, the edge distance of the anchor has to be $\geq 300\text{mm}$ or $\geq 2 x h_{ef}$				

G&B Gamma CE1

Performances
Characteristic values for fire exposure under tension loads

Annex C 3

Table C4: Performances under fire exposure in concrete C20/25 to C50/60 (shear)

Duration of fire resistance = 30min, anchor type Gamma CE 1			M6	M8	M10	M12	M16
Shear load without lever arm							
Characteristic resistance	$V_{Rk,s,fi,30}$	[kN]	0,3	0,5	1,2	2,1	3,9
Shear load with lever arm							
Characteristic bending resistance	$M_{Rk,s,fi,30}^0$	[Nm]	0,2	0,4	1,1	2,6	6,7
Duration of fire resistance = 60min, anchor type Gamma CE 1			M6	M8	M10	M12	M16
Shear load without lever arm							
Characteristic resistance	$V_{Rk,s,fi,60}$	[kN]	0,3	0,4	1,0	1,6	2,9
Shear load with lever arm							
Characteristic bending resistance	$M_{Rk,s,fi,60}^0$	[Nm]	0,1	0,3	1,0	2,0	5,0
Duration of fire resistance = 90min, anchor type Gamma CE 1			M6	M8	M10	M12	M16
Shear load without lever arm							
Characteristic resistance	$V_{Rk,s,fi,90}$	[kN]	0,2	0,3	0,8	1,4	2,5
Shear load with lever arm							
Characteristic bending resistance	$M_{Rk,s,fi,90}^0$	[Nm]	0,1	0,3	0,8	1,7	4,3
Duration of fire resistance = 120min, anchor type Gamma CE 1			M6	M8	M10	M12	M16
Shear load without lever arm							
Characteristic resistance	$V_{Rk,s,fi,120}$	[kN]	0,2	0,2	0,6	1,0	1,9
Shear load with lever arm							
Characteristic bending resistance	$M_{Rk,s,fi,120}^0$	[Nm]	0	0,2	0,6	1,3	3,3
Concrete pryout failure							
The characteristic resistance $V_{Rk,cp,fi,Ri}$ in concrete C20/25 to C50/60 is determined by:							
$V_{Rk,c,fi(90)} = k_g \times N_{Rk,c,fi(90)} (\leq R90)$ and $V_{Rk,c,fi(120)} = k_g \times N_{Rk,c,fi(120)}$ (up to R120)							
Concrete edge failure							
The characteristic resistance $V_{Rk,cp,fi,Ri}$ in concrete C20/25 to C50/60 is determined by:							
$V_{Rk,c,fi(90)}^0 = 0,25 \times V_{Rk,c}^0$ (R30, R60, R90) and $V_{Rk,c,fi(120)}^0 = 0,20 \times V_{Rk,c}^0$ (R120) with							
$V_{Rk,c}^0$ as an initial value of the characteristic resistance of a single anchor in cracked concrete C20/25							

G&B Gamma CE1

Performances

Characteristic values for fire exposure under shear loads

Annex C 4

Table C5: Displacements

Tension loads in cracked and uncracked concrete			M6	M8	M10	M12	M16
Service tension load in uncracked concrete C20/25	N	[kN]	7,6	7,6	9,5	16,7	21,4
Displacements	δ_{N0}	[mm]	1,3	1,5	1,0	1,3	1,8
	$\delta_{N\infty}$	[mm]	1,3	1,5	1,0	1,3	1,8
Service tension load in cracked concrete C20/25	N	[kN]	2,4	2,9	7,6	11,9	16,7
Displacements	δ_{N0}	[mm]	1,0	0,7	1,0	1,2	1,5
	$\delta_{N\infty}$	[mm]	1,6	1,3	1,6	1,7	1,5
Shear loads in cracked and uncracked concrete			M6	M8	M10	M12	M16
Service shear load in cracked and uncracked concrete C20/25	V	[kN]	7,7	12,3	21,0	23,3	52,5
Displacements	δ_{V0}	[mm]	2,4	2,6	2,5	3,0	4,0
	$\delta_{V\infty}$	[mm]	3,6	3,9	3,8	4,5	6,0
Seismic performance category C2							
Damage limit state							
Tension load	$\delta_{N,eq(DLS)}$	[mm]	5,56	5,24	4,23	5,39	6,74
Shear load	$\delta_{V,eq(DLS)}$	[mm]	3,18	5,74	5,12	5,98	6,93
Ultimate limit state							
Tension load	$\delta_{N,eq(ULS)}$	[mm]	22,70	17,65	14,50	16,03	20,59
Shear load	$\delta_{V,eq(ULS)}$	[mm]	4,82	11,02	9,37	9,42	12,96

G&B Gamma CE1

Performances
Displacements

Annex C 5