

Approval body for construction products  
and types of construction

Bautechnisches Prüfamt

An institution established by the Federal and  
Laender Governments



## European Technical Assessment

**ETA-04/0101**  
**of 1 March 2018**

English translation prepared by DIBt - Original version in German language

### General Part

Technical Assessment Body issuing the  
European Technical Assessment:

Deutsches Institut für Bautechnik

Trade name of the construction product

Hilti powder-actuated fastener X-ENP-19 L15 (MX, MXR)

Product family  
to which the construction product belongs

Hilti powder actuated fasteners X-ENP-19 L15, X-ENP-19  
L15 MX, X-ENP-19 L15 MXR in combination with Hilti  
fastening tools DX 76, DX 76 MX, DX 76 PTR,  
DX 860-ENP for fastening of steel sheeting to steel  
members.

Manufacturer

Hilti AG  
Feldkircherstraße 100  
9494 Schaan  
FÜRSTENTUM LIECHTENSTEIN

Manufacturing plant

Hilti Herstellwerk 1  
Feldkircherstraße 100  
9494 Schaan  
FÜRSTENTUM LIECHTENSTEIN

This European Technical Assessment  
contains

12 pages including 7 annexes which form an integral part  
of this assessment

This European Technical Assessment is  
issued in accordance with Regulation (EU)  
No 305/2011, on the basis of

EAD 330153-00-0602

This version replaces

ETA-04/0101 issued on 20 February 2013

**European Technical Assessment  
ETA-04/0101**

**Page 2 of 12 | 1 March 2018**

English translation prepared by DIBt

The European Technical Assessment is issued by the Technical Assessment Body in its official language. Translations of this European Technical Assessment in other languages shall fully correspond to the original issued document and shall be identified as such.

Communication of this European Technical Assessment, including transmission by electronic means, shall be in full. However, partial reproduction may only be made with the written consent of the issuing Technical Assessment Body. Any partial reproduction has to be identified as such.

This European Technical Assessment may be withdrawn by the issuing Technical Assessment Body, in particular pursuant to information by the Commission in accordance with Article 25(3) of Regulation (EU) No 305/2011.

## Specific Part

### 1 Technical description of the product

The products are mechanical fasteners (powder-actuated fasteners / cartridge fired pins)<sup>1</sup> made of carbon steel. The fasteners comprise a pin (nominal diameter: 4.5 mm) which is assembled with two washers. The washers serve to guide the fasteners while they are being driven into the base material. The washers also serve to improve the bearing area. Special fastening tools are used in order to install the fasteners. The driving force of the fastening tools is provided by the power load of the used cartridge (several cartridge strengths available) and can be altered at the fastening tools within a limit. The application limit depends on the strength and the thickness of the base material.

The dimensions and materials of the fasteners are given in Annex A1. The difference of the fastening tools is the kind of feeding: single fasteners or collated in fastener strips. The following overview shows the 5 powder-actuated fastening systems approved.

Fastener	Fastening tool	Features
X-ENP-19 L15	DX 76 DX 76 PTR	These tools are used to drive single fasteners. In case of the DX 76 PTR the single fastener guide X-76-F-15-PTR has to be used.
X-ENP-19 L15 MX	DX 76 MX DX 76 PTR	The fasteners are collated in a MX fastener strip, which is indicated in the fastener designation. The DX 76 MX is based on the DX 76. Instead of the single-fastener guide, it is equipped with the fastener magazine MX 76. The fastener magazine MX 76-PTR is used with the DX 76 PTR.
X-ENP-19 L15 MXR	DX 860-ENP	The fasteners are collated in a MXR fastener strip, which is indicated in the fastener designation. The DX 860-ENP is a stand-up tool in which also collated fasteners are used.

Fasteners, fastening tools and cartridges are shown in Annex A1 and Annex A2.

The fastener and the corresponding connections are subject to tension and/or shear forces (see Annex B2).

### 2 Specification of the intended use in accordance with the applicable European Assessment Document

The intended use is specified in Annex B1 and B2.

The performances given in Section 3 are only valid if the fastener is used in compliance with the specifications and conditions given in Annex B1 to B3.

The verifications and assessment methods on which this European Technical Assessment is based lead to the assumption of a working life of the fastener of at least 25 years. The indications given on the working life cannot be interpreted as a guarantee given by the producer, but are to be regarded only as a means for choosing the right products in relation to the expected economically reasonable working life of the works.

<sup>1</sup> Both terms (powder-actuated fastener and cartridge fired pin) are commonly used.

### 3 Performance of the product and references to the methods used for its assessment

#### 3.1 Mechanical resistance and stability (BWR 1)

Essential characteristic	Performance
Tension resistance of connection	See Annex C1 and C2
Shear resistance of connection	See Annex C1 and C2
Design resistance in case of combined tension and shear forces (interaction)	See Annex B1
Check of deformation capacity in case of constraining forces due to temperature	See Annex B1
Determination and check of application limits	See Annex C1 and C2

#### 3.2 Safety in case of fire (BWR 2)

Essential characteristic	Performance
Reaction to fire	Class A1 according to EN 13501-1:2007+A1:2009
Resistance to fire	See Annex B1

#### 3.3 Hygiene, health and the environment (BWR 3)

Essential characteristic	Performance
Content and/or release of dangerous substances	no performance determined

#### 3.4 Safety and assessability in use (BWR 4)

Essential characteristic	Performance
Tension resistance of connection	See Annex C1 and C2
Shear resistance of connection	See Annex C1 and C2
Design resistance in case of combined tension and shear forces (interaction)	See Annex B1
Check of deformation capacity in case of constraining forces due to temperature	See Annex B1
Determination and check of application limits	See Annex C1 and C2

**3.5 Sustainable use of natural resources (BWR 7)**

Essential characteristic	Performance
Durability	See Annex B1, use conditions

**4 Assessment and verification of constancy of performance (AVCP) system applied, with reference to its legal base**

In accordance with EAD No. 330153-00-0602, the applicable European legal act is: Decision 1998/214/EC, amended by 2001/596/EC.

The system to be applied is: 2+

**5 Technical details necessary for the implementation of the AVCP system, as provided for in the applicable EAD**

Technical details necessary for the implementation of the AVCP system are laid down in the control plan deposited with Deutsches Institut für Bautechnik.

Issued in Berlin on 1 March 2018 by Deutsches Institut für Bautechnik

BD Dipl.-Ing. Andreas Kummerow  
Head of Department

*beglaubigt:*  
Hahn

### Powder-actuated fastener / cartridge fired pin X-ENP-19 L15

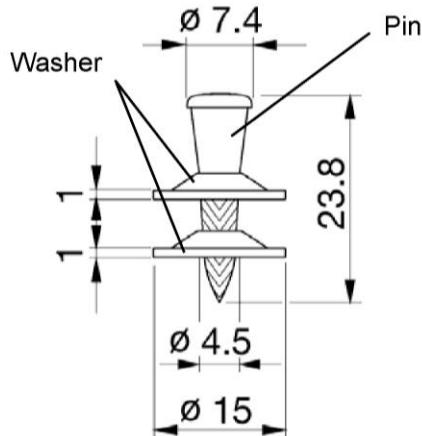

**Material:**

Pin Steel C67S in keeping with EN 10132-4 tempered, quenched and galvanised. Nominal hardness: 58 HRC

Washer Steel DC01 galvanised according to EN 10139

Zinc coating to resist 2 cycles Kesternich test with 2 l SO<sub>2</sub> according to EN 3231 without red rust

### Example of powder-actuated fastening tool and cartridge



Detail of wheel on tool allowing continuous regulation of the driving energy within one cartridge colour:

- Setting 1: Minimum energy
- Setting 4: Maximum energy

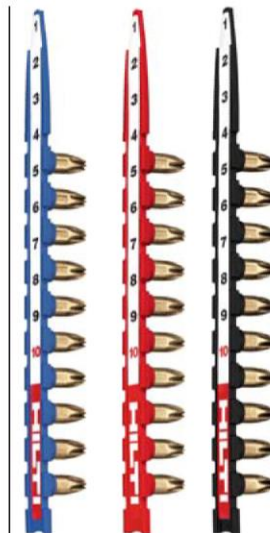

Catridges 6,8/18 M10 with 10 cartridges per plastic strip for DX 76, DX 76 PTR

- Blue: Medium load (level 5)
- Red: Medium high load (level 6)
- Black: Extra high load (level 7)

Catridges 6,8/18 M40 with 40 cartridges per plastic strip for DX 860-ENP

electronic copy of the eta by dibt: eta-04/0101

**Hilti powder-actuated fastener X-ENP-19 L15 (MX, MXR)**

**Product description**  
Product, dimension and material

**Annex A1**

<p>Single Fastener: <b>X-ENP-19 L15</b></p> 	<p>Collated fasteners for magazine tools: <b>X-ENP-19 L15 MX</b></p> 	
<p><b>DX 76</b></p> 	<p><b>DX 76 MX</b></p> 	
<p><b>DX 76 PTR</b> with single- fastener guide X-76-F-15-PTR</p> 	<p><b>DX 76 PTR</b> with magazine MX 76-PTR</p> 	
<p>Collated fasteners for stand-up tools: <b>X-ENP-19 L15 MXR</b></p> 	 <p><b>DX 860-ENP</b></p>	
<p><b>Hilti powder-actuated fastener X-ENP-19 L15 (MX, MXR)</b></p>		<p><b>Annex A2</b></p>
<p><b>Product description</b> Powder-actuated fastening tools</p>		

### Specification of intended use

The fasteners are intended to be used for fastening of steel sheeting to steel members. The sheeting can either be used as cladding or as load bearing wall and roof element.

#### Anchorage subject to:

- Predominantly static and quasi-static loads. Wind loads are regarded as predominantly static.

#### Fixed material sheeting (flat products and therewith produced profiled products):

- Steel sheeting of steel grades  $\geq$  S280 according to EN 10346:2015 and a thickness  $t_t = 0.63$  mm to 2.5 mm (with max 4 mm for 2 to 4 layers).
- Other thin gauge steel members.

#### Base materials:

- Structural steel  $\geq$  S235 with a thickness  $t_{II} \geq 6$  mm provided the relevant application limits (Annex C1 and Annex C2) are taken into account.
- For hot-dipped galvanized base materials a zinc coating up to approximately 150  $\mu$ m is allowed, for powder-coated or painted base materials a dry coat thickness of up to 160  $\mu$ m is allowed.

#### Use conditions (Environmental conditions):

- The intended use only comprises fasteners and connections which are not directly exposed to external weather conditions or moist atmospheres.

#### Design:

- The verification concept stated in EN 1990:2002 + A1:2005 + A1:2005/AC:2010 is used for the design of the connection made with the fasteners. The characteristic values (shear and tension resistance) according to Annex C1 and Annex C2 are used for the design of the entire connection.
- The partial safety factor of  $\gamma_M = 1.25$  is used in order to determine the corresponding design resistance, provided no values are given in national regulations of the member state in which the fastener is used or in the respective National Annex to Eurocode 3.
- In case of combined tension and shear forces the linear interaction formula according to EN 1993-1-3:2006 + AC:2009, section 8.3 (8) is taken into account.
- The possibly required reduction of the tension resistance due to the position of the fastener is taken into account in accordance with EN 1993-1-3:2006 + AC:2009, section 8.3 (7) and Fig. 8.2.
- For the type of connection (a, b, c, d) listed in Annex C1 and Annex C2 it is not necessary to take into account the effect of constraints due to temperature for the steel grades S280 and S320 in accordance with EN 10346:2015. For steel grades  $\geq$  S350 in accordance with EN 10346:2015 it shall be considered for design.
- Dimensions, material properties, application limits and nail head standoffs as stated in the ETA are observed.
- Resistance to fire: The part of the structure in which the powder-actuated fasteners X-ENP-19 L15 are intended to be installed shall be tested, using the test method relevant for the corresponding fire resistance class, in order to be classified according to the appropriate part of EN 13501.

#### Installation:

- The installation is only carried out according to the manufacturer's instructions. The manufacturer hands over the assembly instructions to the assembler.
- The installation is carried out such that the fasteners are replaceable if necessary.
- The steel sheeting is in direct contact with the steel base material in the area of the connection.
- The conformity of the installed fastener with the provisions of the ETA is attested by the executing company.

**Hilti powder-actuated fastener X-ENP-19 L15 (MX, MXR)**

**Intended use**  
Specification

**Annex B1**



### Types of connection and corresponding loading conditions

	Types of connection			
	Type a	Type b	Type c	Type d
Type of loading	Single connection	Side lap connection	End overlap connection	Side lap + end overlap connection
Shear loading				
Tension loading				

**Fixed material thickness  $t_I$ , base material thickness  $t_{II}$  and nail head standoff  $h_{NVS}$**

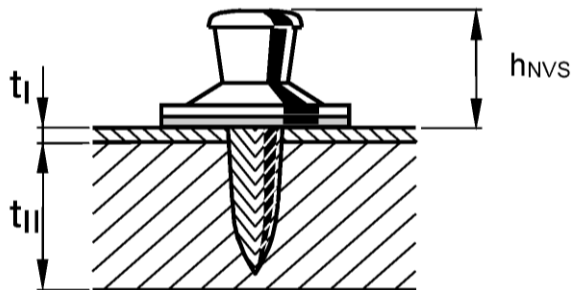

electronic copy of the eta by dibt: eta-04/0101

Hilti powder-actuated fastener X-ENP-19 L15 (MX, MXR)

**Intended use**  
Types of connection

**Annex B2**

## Instructions for use

- The powder-actuated fasteners X-ENP-19 L15, X-ENP-19 L15 MX and X-ENP-19 L15 MXR are driven by using the powder-actuated fastening tools DX 76, DX 76 PTR and DX 860-ENP as shown in Annex A2.
- The steel sheeting is in direct contact with the steel supporting structure at the area of the connection. Cartridge selection and tool energy settings in order to cover the application limit diagram are taken into account as given in Annex C1 and Annex C2.
- Installation safety tests are to be carried out (e.g. check of nail head standoff  $h_{NVS}$ ), provided the fitness of the recommended cartridge cannot be checked otherwise. Fine regulation of the driving energy by using the wheel on the fastening tool is acceptable in order to meet the nail head standoff  $h_{NVS}$ .
- The powder-actuated fastener is properly set if the metal sheet tightened against the steel surface and the nail head standoff  $h_{NVS}$  is in accordance with the requirements given in Annex C1 and Annex C2. A piston mark on the top washer is clearly visible.

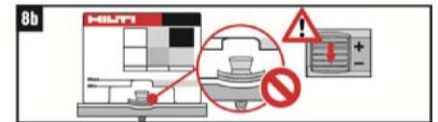
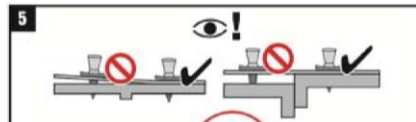
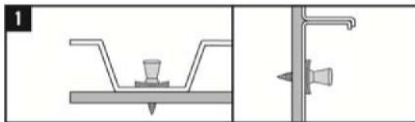
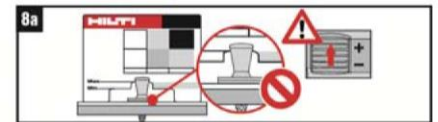
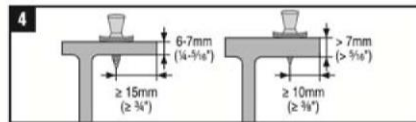
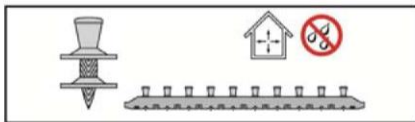

2	X-ENP-19 L15 MXR	DX 860-ENP DX 76 PTR	6.8 / 18 M40
	X-ENP-19 L15 MX	DX 76 MX DX 750 MX	6.8 / 18 M10
	X-ENP-19 L15	DX 76 F15 DX 750	

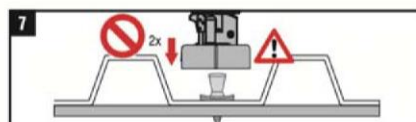
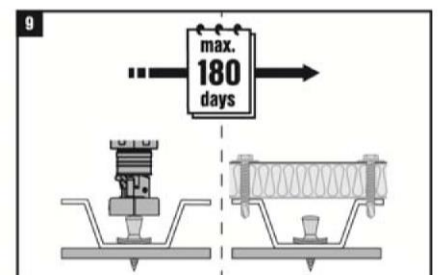
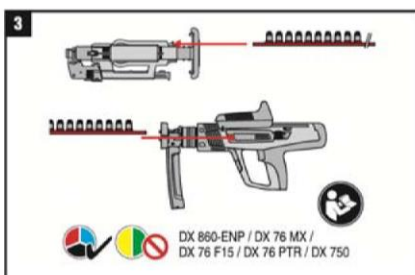
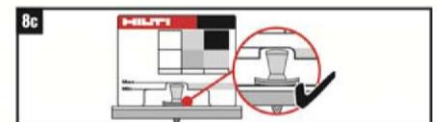
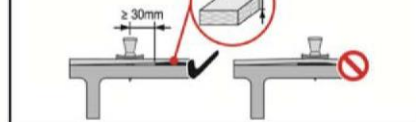

Hilti powder-actuated fastener X-ENP-19 L15 (MX, MXR)

Intended use  
Instructions for use

Annex B3

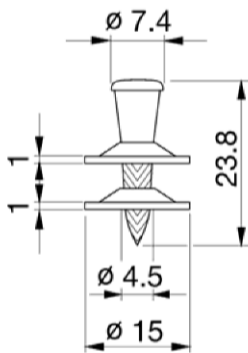

Powder-actuated fastener and fastening tool:

**X-ENP-19 L15 with DX 76**  
**X-ENP-19 L15 MX with DX 76 MX**  
**X-ENP-19 L15 MXR with DX 860-ENP**

Piston: **X-76-P-ENP**

Cartridges: **6.8/18 M10 (DX 76, DX 76 MX)**  
**6.8/18 M40 (DX 860-ENP)**

Installation control:

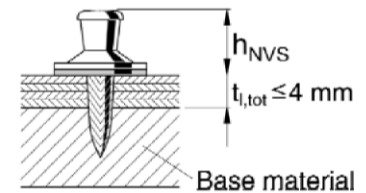

$h_{NVS} = 8.2 \text{ to } 9.8 \text{ mm}$

A piston mark on the top washer is clearly visible.

Characteristic shear and tension resistance $V_{Rk}$ and $N_{Rk}$				Design shear and tension resistance $V_{Rd}$ and $N_{Rd}$	
sheeting thickness $t_i$ [mm]	Shear $V_{Rk}$ [kN]	Tension $N_{Rk}$ [kN]	Types of connection	$V_{Rd} = V_{Rk} / \gamma_M$	$N_{Rd} = \alpha_{cycl} \cdot N_{Rk} / \gamma_M$
0.63	4.0	4.1	a,b,c,d	$\gamma_M = 1.25$ in the absence of national regulations	$\alpha_{cycl} = 1.0$
0.75	4.7	6.3	a,b,c,d		$\alpha_{cycl}$ considers the effect of repeated wind loads
0.88	5.4	7.2	a,b,c,d		$\alpha_{cycl} = 1.0$ for all sheeting thickness $t_i$
1.00	6.0	8.0	a,b,c,d		$\gamma_M = 1.25$ in the absence of national regulations
1.13	7.0	8.4	a,c		
1.25	8.0	8.8	a,c		
1.50	8.6	8.8	a		
1.75	8.6	8.8	a		
2.00	8.6	8.8	a		
2.50	8.6	8.8	a		

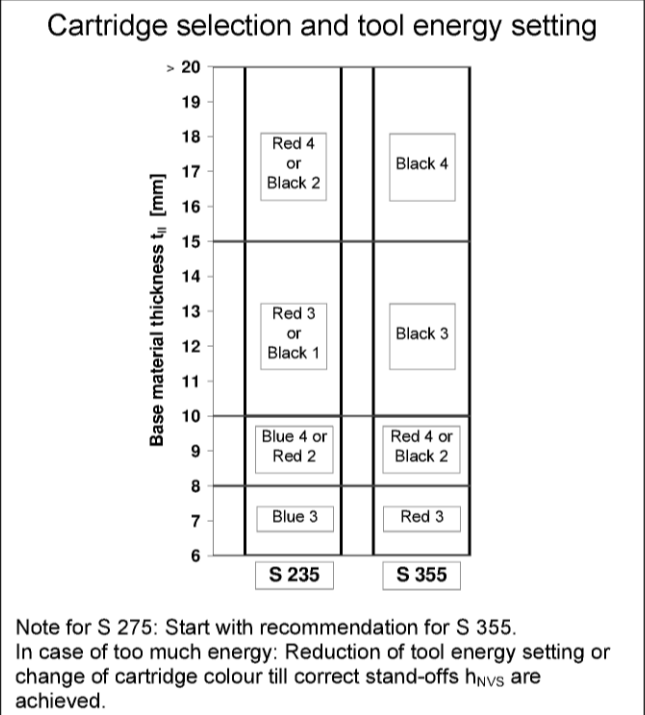
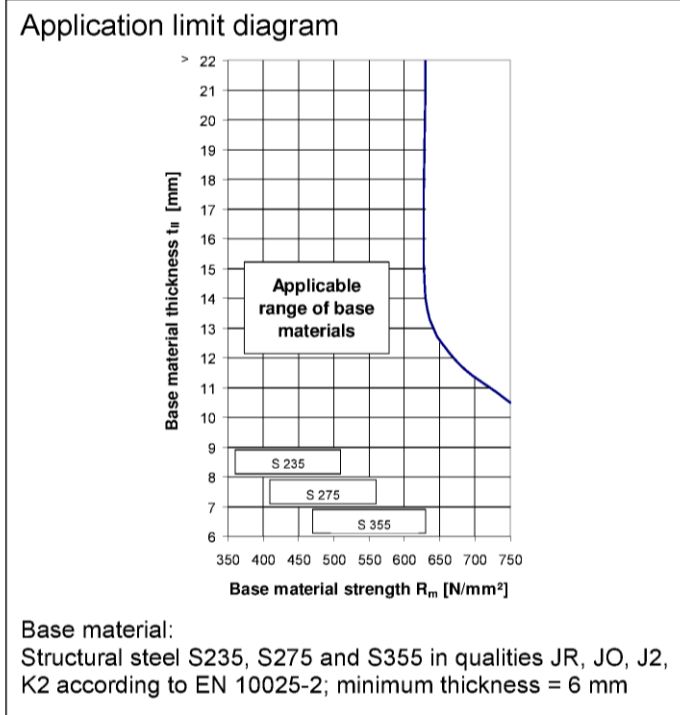

electronic copy of the eta by dibt: eta-04/0101

**Hilti powder-actuated fastener X-ENP-19 L15 (MX, MXR)**

**Performances**

X-ENP-19 L15 with tools DX 76, DX 76 MX and DX 860-ENP: Characteristic and design resistance, application limit, cartridge selection and nail head standoff

**Annex C1**

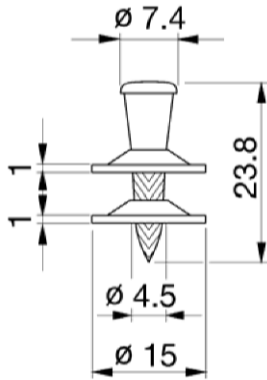

Powder-actuated fastener and fastening tool:

**X-ENP-19 L15 with DX 76 PTR and single-fastener guide X-76-F-15-PTR**

**X-ENP-19 L15 MX with DX 76 PTR and -fastener magazine MX 76-PTR**

Piston: **X-76-P-ENP-PTR**

Cartridges: **6.8/18 M10**

Installation control:

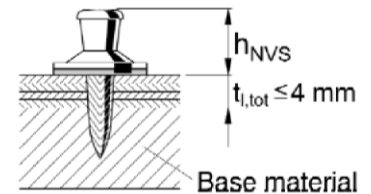

$h_{NVS} = 8.2 \text{ to } 9.8 \text{ mm}$

A piston mark on the top washer is clearly visible.

**Characteristic shear and tension resistance  $V_{Rk}$  and  $N_{Rk}$**

sheeting thickness $t_i$ [mm]	Shear $V_{Rk}$ [kN]	Tension $N_{Rk}$ [kN]	Types of connection
0.75	4.7	6.3	a,b,c,d
0.88	5.4	7.2	a,b,c,d
1.00	6.0	8.0	a,b,c,d
1.13	7.0	8.4	a,c
1.25	8.0	8.8	a,c
1.50	8.6	8.8	a
1.75	8.6	8.8	a
2.00	8.6	8.8	a
2.50	8.6	8.8	a

**Design shear and tension resistance  $V_{Rd}$  and  $N_{Rd}$**

$$V_{Rd} = V_{Rk} / \gamma_M$$

$$N_{Rd} = \alpha_{cycl} \cdot N_{Rk} / \gamma_M$$

$$\alpha_{cycl} = 1.0$$

$\gamma_M = 1.25$  in the absence of national regulations

$\alpha_{cycl}$  considers the effect of repeated wind loads

$\alpha_{cycl} = 1.0$  for all sheeting thickness  $t_i$

$\gamma_M = 1.25$  in the absence of national regulations

**Application limit diagram**

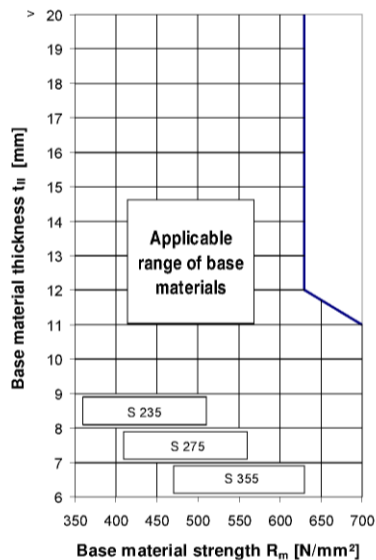

Base material:  
Structural steel S235, S275 and S355 in qualities JR, JO, J2, K2 according to EN 10025-2; minimum thickness = 6 mm

**Cartridge selection and tool energy setting**

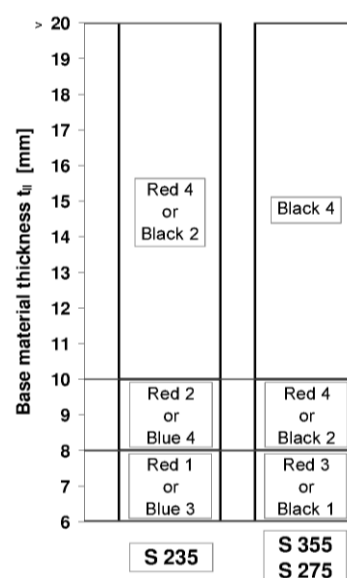

**Hilti powder-actuated fastener X-ENP-19 L15 (MX, MXR)**

**Performances**

X-ENP-19 L15 with tool DX 76 PTR: Characteristic and design resistance, application limit, cartridge selection and nail head standoff

**Annex C2**