

Approval body for construction products
and types of construction

Bautechnisches Prüfamt

An institution established by the Federal and
Laender Governments



European Technical Assessment

ETA-17/0575
of 16 April 2021

English translation prepared by DIBt - Original version in German language

General Part

Technical Assessment Body issuing the
European Technical Assessment:

Deutsches Institut für Bautechnik

Trade name of the construction product

Multi-axis concealed hinges
Kubica K2400, Kubica K5080, Kubica K6200, Kubica
Hybrid K2460

Product family
to which the construction product belongs

Multi-axis concealed hinges
Kubica K2400, Kubica K5080, Kubica K6200, Kubica
Hybrid K2460

Manufacturer

KRONA KOBLENZ S.p.A
Via o. Romero 1
47853 CORIANO (RN)
ITALIEN

Manufacturing plant

KRONA KOBLENZ S.p.A
Via o. Romero 1
47853 CORIANO (RN)
ITALIEN

This European Technical Assessment
contains

9 pages including 5 annexes which form an integral part
of this assessment

This European Technical Assessment is
issued in accordance with Regulation (EU)
No 305/2011, on the basis of

EAD 020001-01-0405

This version replaces

ETA-17/0575 issued on 15 December 2017

European Technical Assessment

ETA-17/0575

English translation prepared by DIBt

Page 2 of 9 | 16 April 2021

The European Technical Assessment is issued by the Technical Assessment Body in its official language. Translations of this European Technical Assessment in other languages shall fully correspond to the original issued document and shall be identified as such.

Communication of this European Technical Assessment, including transmission by electronic means, shall be in full. However, partial reproduction may only be made with the written consent of the issuing Technical Assessment Body. Any partial reproduction shall be identified as such.

This European Technical Assessment may be withdrawn by the issuing Technical Assessment Body, in particular pursuant to information by the Commission in accordance with Article 25(3) of Regulation (EU) No 305/2011.

Specific Part

1 Technical description of the product

This European Technical Assessment applies to the variable concealed multi-axis hinges made of aluminium and zinc die casting with the designation "Kubica K2400", "Kubica K5080", "Kubica K6200" or made of steel and Zamac with the designation "Kubica Hybrid K2460".

Each product consists of three parts, one part a mounting plate for the door frame, one part a mounting plate for the door leaf with segmented plates connected laterally in such a way as to allow the door to swing freely and to maintain the leaf in the same horizontal and vertical plane during the full operational cycle. Between the two mounting plates provide a variable geometry moving axis within a concealed hinge assembly.

The system setup of the product is given in Annexes 1 to 4.

The further labelling of some hinges is according to Annex 5.

2 Specification of the intended use in accordance with the applicable European assessment Document

The hinges are intended for use on doors of timber and metal. The doors could be made of synthetic materials if there is no requirement on resistance to fire.

They are invisible (concealed) hinges to allow single and double swing door leaves to be mounted flush to its door leaf and frame, forming a flush panel surface when the door is closed, and allowing the door to open to 180°.

The hinges are available for use on doors with door mass up to 40 kg (Kubica K2400, Kubica K6200) or 60 kg (Kubica Hybrid K2460) or 80 kg (Kubica K5080) each door leaf.

The verifications and assessment methods on which this European Technical Assessment is based lead the assumption of working life of the hinges of 10 years. The indications given on the working life cannot be interpreted as a guarantee given by the producer, but are to be regarded only as a means for choosing the right products in relation to the expected economically reasonable working life of the works.

3 Performance of the product and references to the methods used for its assessment

3.1 Safety in case of fire (BWR 2)

Essential characteristic	Performance
Reaction to fire	Performance class A1
Resistance to fire	EI 2 30

3.2 Sustainable use of natural resources (BWR 7)

For the sustainable use of natural resources, no performance was investigated for this product.

3.3 General aspects

The verification of durability is part of testing the essential characteristics.

Essential characteristic	Performance
Category of use	Grade 2 - KUBICA K2400 KUBICA K6200 KUBICA HYBRID K2460 Grade 3 - KUBICA K5080
Durability	Grade 7
Test door mass	Grade 2 - KUBICA K2400 KUBICA K6200 Grade 3 - KUBICA HYBRID K2460 Grade 4 - KUBICA K5080
Fire resistance	Grade 1
Safety	Grade 1
Corrosion resistance	Grade 4
Security	Grade 0
Hinge grade	Grade 7 - KUBICA K2400 KUBICA K6200 Grade 10 - KUBICA HYBRID K2460 Grade 11 - KUBICA K5080

4 Assessment and verification of constancy of performance (AVCP) system applied, with reference to its legal base

According to Decision of the Commission 1999/93/EC (OJ L 29/51 of 26.01.1999 p. 51), as amended by Decision of the Commission 2011/246/EU (Letter of the European commission of 15/10/2004), the system of assessment and verification of constancy of performance (see Annex V and Article 65 Paragraph 2 to Regulation (EU) No 305/2011) given in the following table applies.

The system to be applied is: 1

5 Technical details necessary for the implementation of the AVCP system, as provided for in the applicable EAD

Technical details necessary for the implementation of the AVCP system are laid down in the control plan deposited at Deutsches Institut für Bautechnik.

Issued in Berlin on 16. April 2021 by Deutsches Institut für Bautechnik

Christina Pritzkow
Head of section

beglaubigt:
Panneck

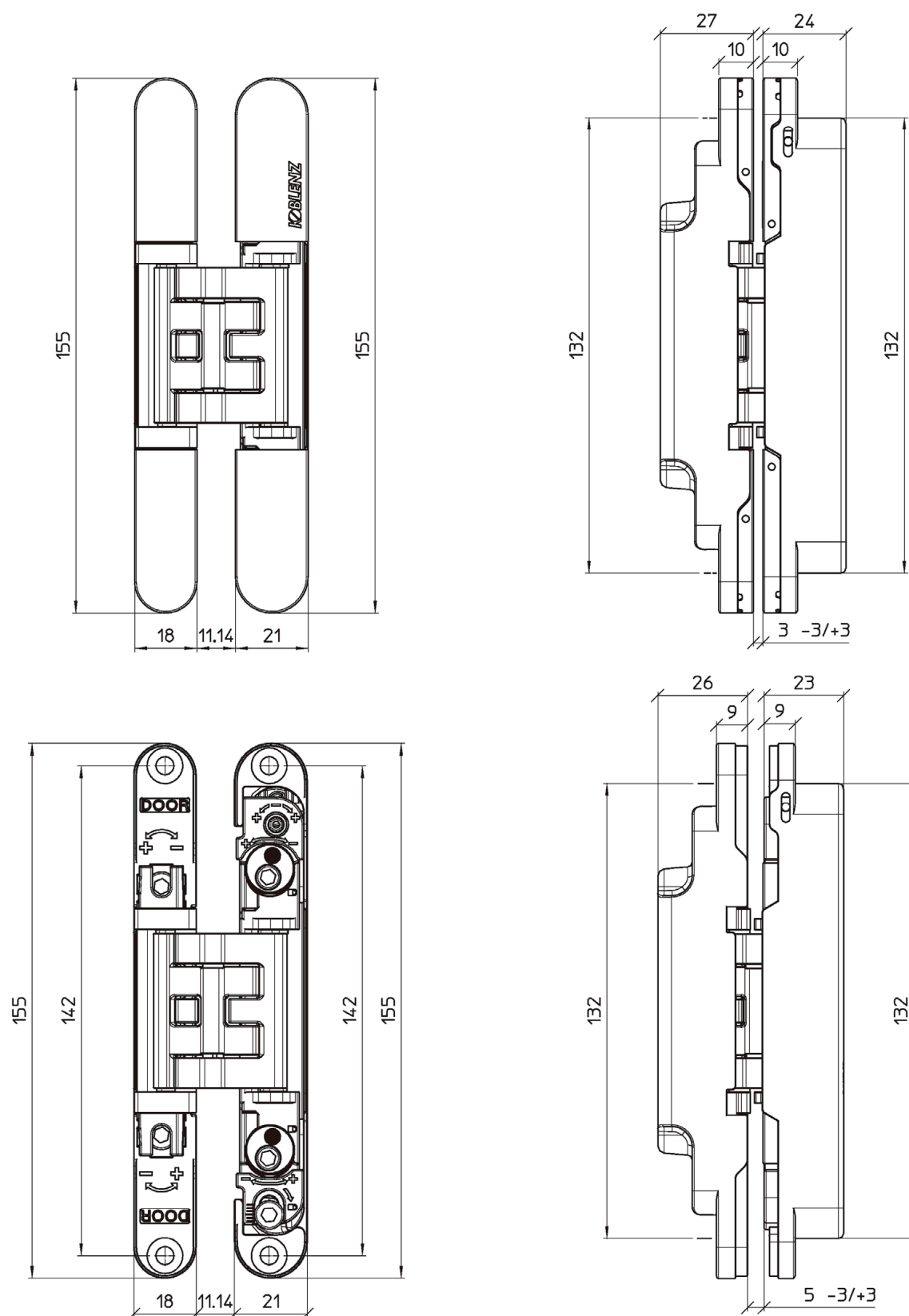

Multi-axis concealed hinges
Kubica K2400, Kubica K5080, Kubica K6200, Kubica Hybrid K2460

Construction Kubica K2400

Annex 1

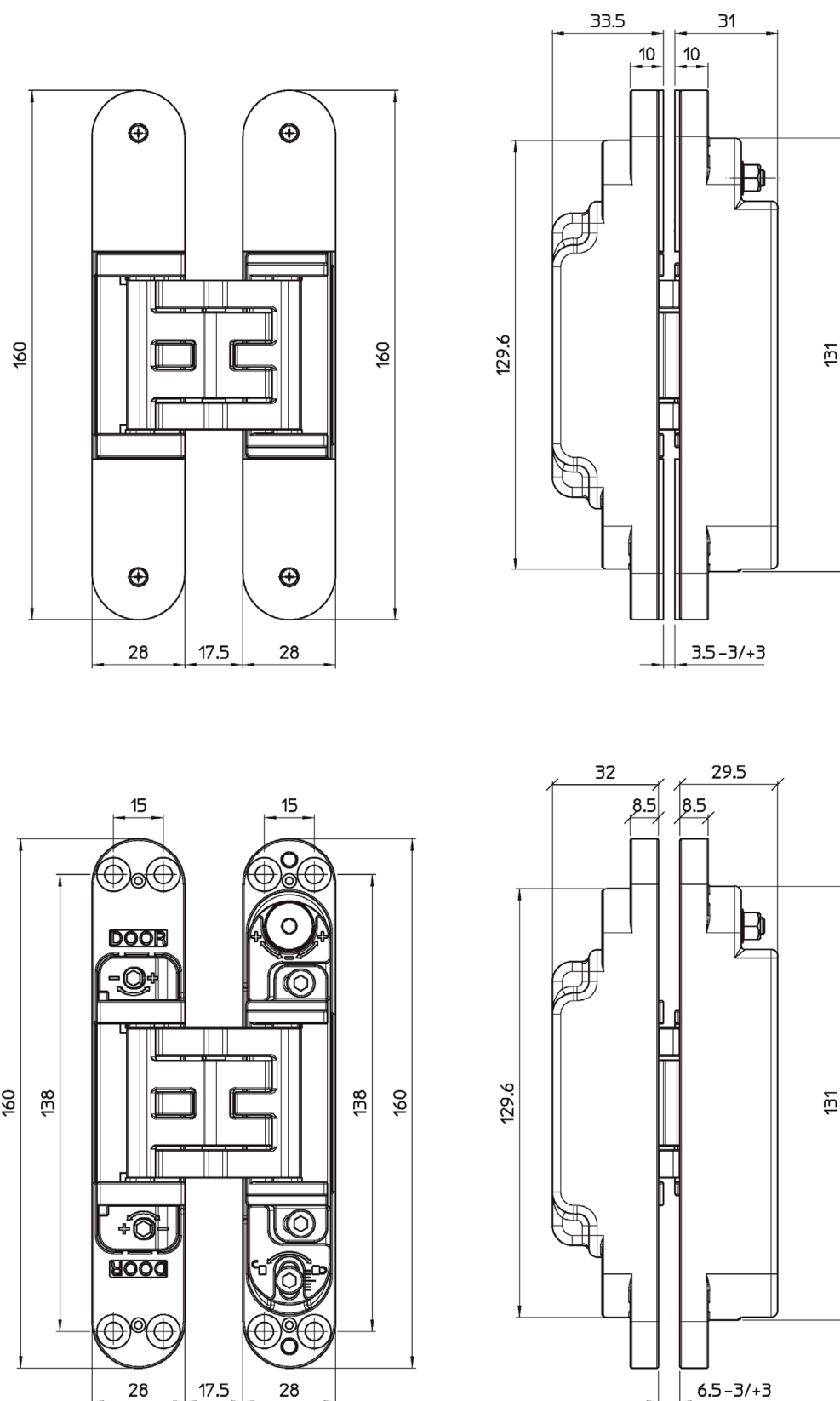

Multi-axis concealed hinges
Kubica K2400, Kubica K5080, Kubica K6200, Kubica Hybrid K2460

Construction Kubica K5080

Annex 2

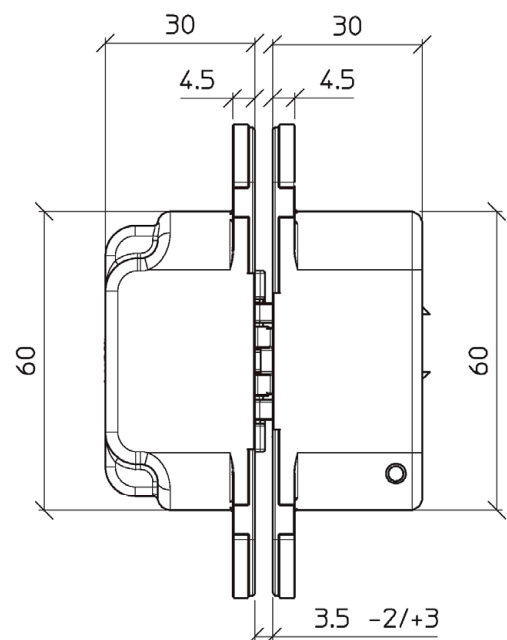
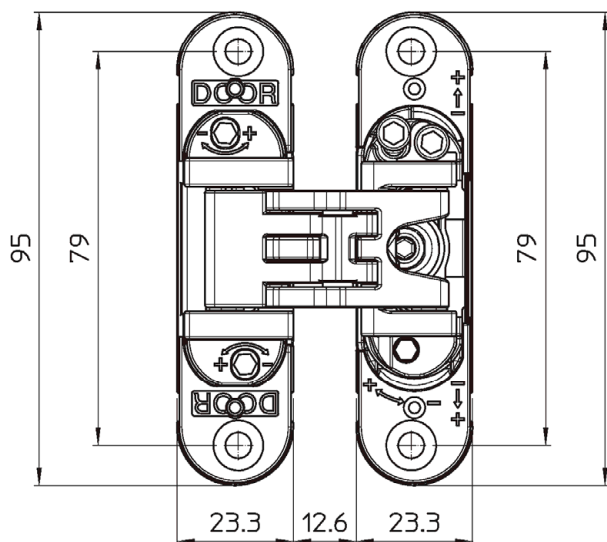
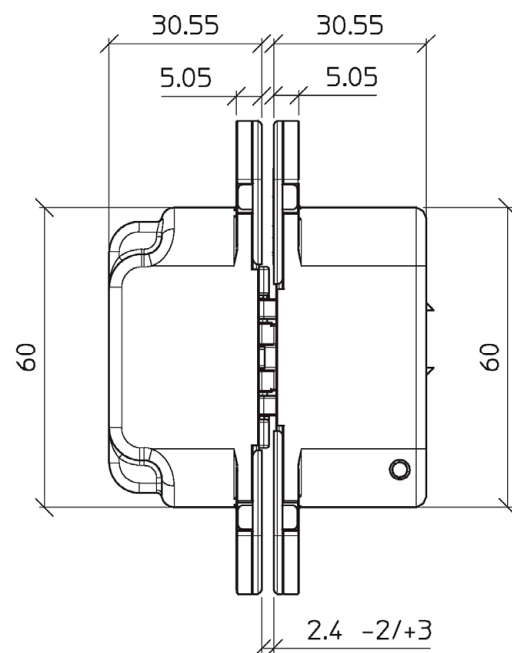
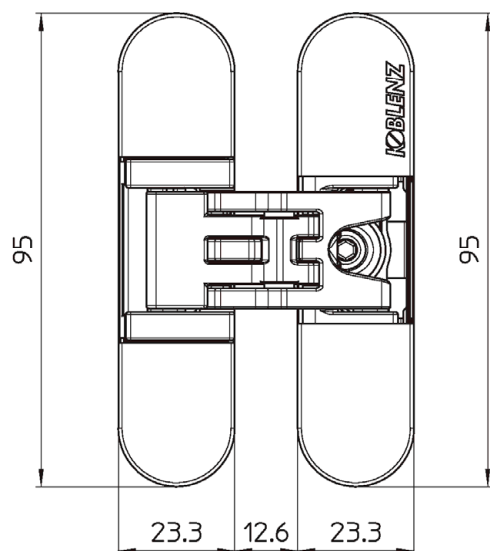

Multi-axis concealed hinges
Kubica K2400, Kubica K5080, Kubica K6200, Kubica Hybrid K2460

Construction Kubica K6200

Annex 3

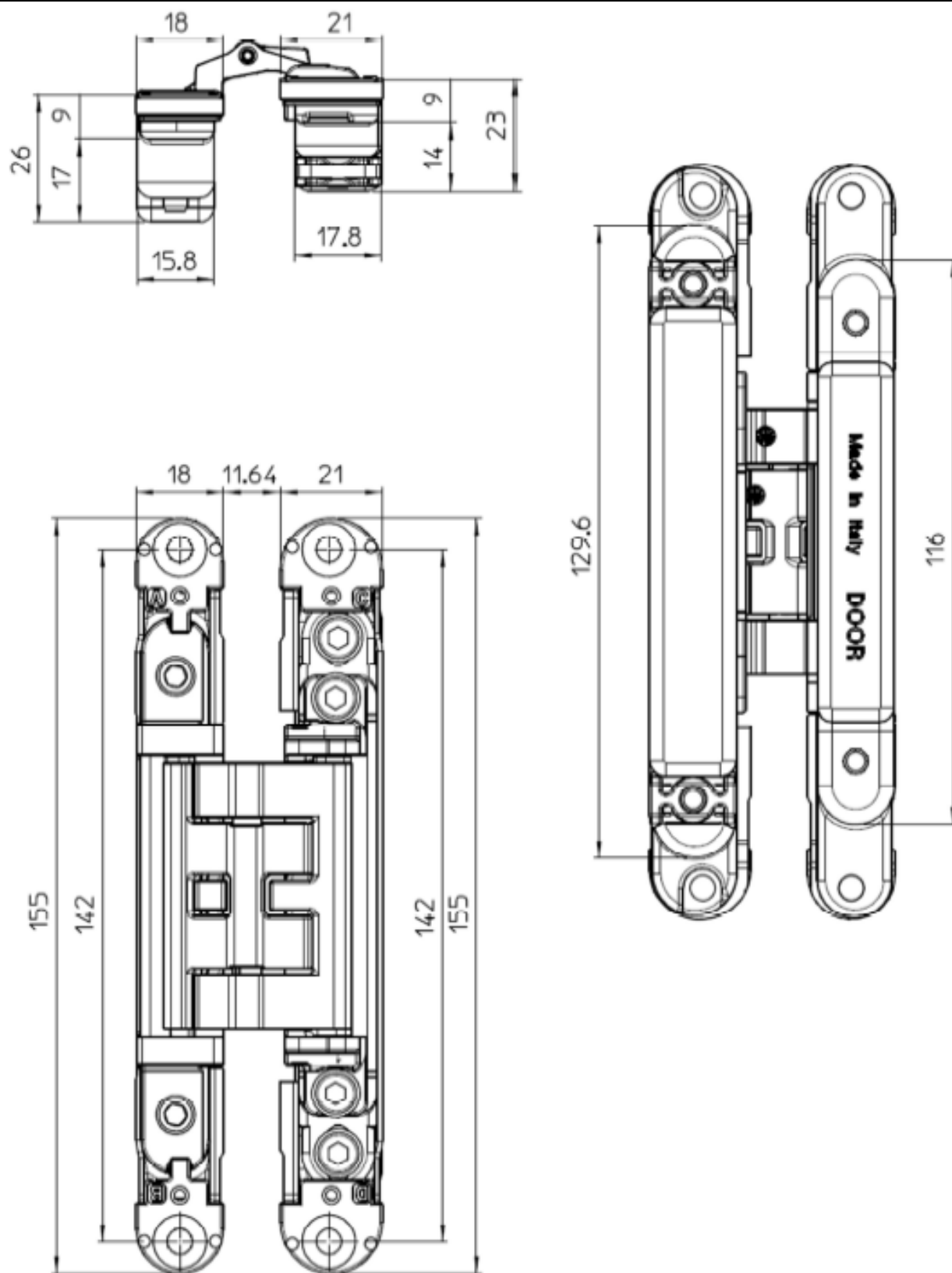

Multi-axis concealed hinges
Kubica K2400, Kubica K5080, Kubica K6200, Kubica Hybrid K2460

Construction Kubica Hybrid K2460

Annex 4

Kubica K2400	927.91.542 927.91.543	---	---
Kubica K5080	927.91.041 927.91.043 927.91.044 927.91.046 927.91.048	---	---
Kubica K6200	927.91.542 927.91.543 927.91.544 927.91.546 927.91.548	0688 313 655	---
Kubica Hybrid K2460	927.91.120 927.91.121 927.91.122 927.91.123 927.91.124 927.91.125 927.91.126 927.91.127 927.91.128 927.91.129 102265793	Spirit 240-3D 0687 383 100 0687 383 101 0687 383 102 0687 383 103 0687 383 104 0687 383 105 0687 383 106 0687 383 107 0687 383 108 0687 383 109 K2460/CS-05 K2460/NO-74 K2460/NS-20	76060 76060.01 76060.02 76060.03 76060.04 76060.05 76060.06 76060.07 76060.08 76060.09 76060.10 76060.11 76060.12

Multi-axis concealed hinges
Kubica K2400, Kubica K5080, Kubica K6200, Kubica Hybrid K2460

Further labelling of some hinges according to applicants information

Annex 5